



1       **WHEREAS**, after reviewing the bids and proposals set forth above, the  
2 Department of the County Recorder has determined that certain bids and proposals  
3 represent the lowest and best bid for the respective items or services and met the bid or  
4 proposal specifications issued by the County; and

5       **WHEREAS**, the Jefferson County, Missouri, Council finds it is in the best interest  
6 of the County to award the bids and proposals to E.A. Boyer Building & Design, Inc. for a  
7 term from 2-28-17 to 2-27-18 upon approval by the County Council and County Executive  
8 for the total amount up to **\$18,300.00** subject to budgetary limitations.

9       **BE IT ENACTED BY THE JEFFERSON COUNTY, MISSOURI, COUNCIL,**  
10 **AS FOLLOWS:**

11       Section 1.     The County awards the following bids and proposals which are  
12 incorporated by this reference as if fully set out herein, to the lowest and best vendor  
13 bidding for each respective item or service as follows:

14                               BID NAME  
15                               Jefferson County Recorder's Office  
16                               Remodel of Customer Service Area

17                               TERM  
18                               2-28-17 to 2-27-18  
19                               Upon approval by the County Council and County Executive

20                               AMOUNT  
21                               Up to **\$18,300.00**  
22                               subject to budgetary limitations

### AWARDED BIDDER

E.A. Boyer Building & Design, Inc.

Section 2. The Jefferson County, Missouri, Council hereby authorizes the County Executive to execute the agreement incorporated by Reference as Exhibit “A” and any agreements or contracts necessary to effectuate the award of the bids and proposals set forth in this Ordinance. The County Executive is further authorized to take any and all actions necessary to carry out the intent of this Ordinance. An unexecuted copy of the Agreement is attached hereto as Exhibit “A” and incorporated herein, by reference.

Section 3. Copies of all Invitations for Bid, Requests for Proposals, responses thereto, and any contracts or agreements shall be maintained by the Department of the County Clerk consistent with the rules and procedures for the maintenance and retention of records as promulgated by the Secretary of State.

Section 4. This Ordinance shall be in full force and effect from and after its date of approval. If any part of this Ordinance is invalid for any reason, such invalidity shall not affect the remainder of this Ordinance.

**THIS BILL BEING DULY INTRODUCED, THE MEMBERS OF THE  
JEFFERSON COUNTY, MISSOURI, COUNCIL VOTED AS FOLLOWS:**

Council Member District 1, Don Bickowski	<u>yes</u>
Council Member District 2, Renee Reuter	<u>yes</u>
Council Member District 3, Robert Boyer	<u>yes</u>
Council Member District 4, Charles Groeteke	<u>yes</u>
Council Member District 5, Oscar J. "Jim" Kasten	<u>yes</u>
Council Member District 6, Daniel Stallman	<u>absent</u>
Council Member District 7, James Terry	<u>yes</u>

**THE ABOVE BILL ON THIS 27<sup>th</sup> DAY OF February, 2017:**

✓ **PASSED**             **FAILED**

  
Renee Reuter, County Council Chair

  
Pat Schlette, Council Administrative Assistant

THIS BILL WAS ✓ APPROVED BY THE JEFFERSON COUNTY  
EXECUTIVE AND ENACTED AS AN ORDINANCE OF JEFFERSON COUNTY,  
MISSOURI, THIS 1ST DAY OF MARCH, 2017.

THIS BILL WAS \_\_\_\_\_ VETOED AND RETURNED TO THE  
JEFFERSON COUNTY, MISSOURI, COUNCIL WITH WRITTEN OBJECTIONS  
BY THE JEFFERSON COUNTY EXECUTIVE, THIS \_\_\_\_\_ DAY OF  
\_\_\_\_\_, 2017.

*Kenneth B. Waller*

Kenneth B. Waller, Jefferson County, Missouri, Executive

**ATTEST:**

*Randy B. Holman*  
Randy B. Holman, County Clerk

BY: *Katherine E. Missey*

Reading Date: 02-27-2017



JEFFERSON COUNTY  
DEPARTMENT OF ADMINISTRATIVE SERVICES  
729 MAPLE ST / PO BOX 100  
HILLSBORO MO 63050  
WWW.JEFFCOMO.ORG

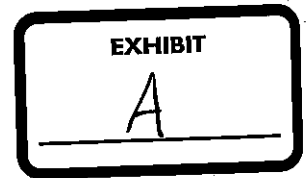

BID #: 17-0004

Request for Proposal: JEFFERSON COUNTY RECORDER'S OFFICE  
REMODEL OF CUSTOMER SERVICE AREA

Date Issued: 12-21-2016

PROPOSALS SHALL BE ACCEPTED UNTIL: TUESDAY, JANUARY 24, 2017, AT 2:00 P.M. LOCAL TIME.

Specification  
Contact:

**KERRY ROGERS**  
Department of Facilities  
636-797-5011  
krogers@jeffcomo.org

Contract  
Contact:

**VICKIE PRATT**  
Department of Administrative Services  
636-797-5380

Mail (3) Three  
Complete Copies  
With Vendor And  
Proposal  
Information As  
Shown In Sample:

SAMPLE ENVELOPE

VENDOR NAME  
VENDOR ADDRESS  
CONTACT NUMBER  
DEPARTMENT OF THE COUNTY CLERK  
JEFFERSON COUNTY MISSOURI  
729 MAPLE ST / PO BOX 100  
HILLSBORO MO 63050-0100  
SEALED PROPOSAL: (PROPOSAL NAME)

Contract Term:  
upon approval by  
the County Council  
and County  
Executive

The undersigned certifies that he/she has the authority to bind this company in an agreement/contract to supply the commodity or service in accordance with all terms, conditions, and pricing specified. This Proposal, if accepted, will constitute an Agreement and Contract with Jefferson County, Missouri, upon approval of the County Council and County Executive. Prices are firm during this agreement term, unless agreed upon in writing by the County. The County has the option to renew this agreement at the same terms and conditions as the original agreement for one additional one-year term with the written consent of the successful bidder. Price increases for renewals are not authorized unless approved in writing by the County.

Vendor  
Information:

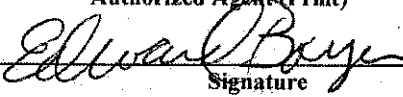
EA Boyer Bldg & Design, Inc	Edward Boyer
Company Name	Authorized Agent (Print)
1701 Towne View Dr	
Address	Signature
DeSoto, MO 63020	President
City/State/Zip Code	Title
636-337-9119	1/24/2017
Telephone #	Date
eaboyer9119@sbcglobal.net	43-1437666
E-mail	Tax ID #
	636-586-9810
	Fax #

## **TABLE OF CONTENTS:**

<b>Legal Notice and Request for Proposal</b>	<b>Page 1</b>
<b>Table of Contents</b>	<b>Page 2</b>
<b>Proposal Requirements</b>	<b>Page 3</b>
<b>Proposal Form and Contract</b>	<b>Page 5</b>
<b>Affidavit</b>	<b>Page 9</b>
<b>Specifications</b>	<b>Page 11</b>

## **\*REQUIRED DOCUMENTS\***

1. Current and valid Certificate of Insurance or binder showing required insurance coverage must be provided with each bid.  
(County must be added as additional insured if awarded)
- 2a. Proof that Bidder does not owe delinquent real or personal property in Jefferson County (tax receipts for past 3 years)  
Obtain receipts at <http://jeffersonmo.devnetwedge.com>  
Or
- 2b. A notarized affidavit stating that the applicant does not own any real or personal property in Jefferson County on company letterhead.
3. A Notarized affidavit of work authorization and current business entity status with E-verification documentation (pages 9 & 10).
4. Agreement to be executed by the County upon approval by the County Council and County Executive (Bidder is required to complete company information and execute signature).
5. Cooperative Bid Form (last page)
6. All pages of the Invitation for Bid/Request for Proposal must be used when submitting your bid/proposal response along with initialing each page with the bid/proposal. Additional information may be included separately.
7. Bid deposits/bonds must be in the exact amount as stipulated in the bid. (if required)

**\*BIDS MAYBE REJECTED IF REQUIRED DOCUMENTATION IS NOT INCLUDED OR COMPLETED AT DISCRETION OF THE COUNTY**

## PROPOSAL REQUIREMENTS

Bidder shall initial all pages and return where the Bid Document denotes

"BIDDER'S INITIALS: EB"

**A. PROPOSAL SUBMISSION:**

Submit bid form in original (one original) and two (two copies) with all specification pages, if applicable. No facsimile or electronic proposals shall be accepted and shall be rejected. A fully executed Affidavit is required by Section 285.530 RSMo and shall be submitted with the proposal form. A copy of the Affidavit is attached hereto. Failure to execute the Affidavit shall result in the proposal being rejected. Vendor shall comply with the requirements of Sections 285.525 to 285.555 of the Revised Statutes of the State of Missouri. If any part of the work is subcontracted, each subcontractor shall comply with the same requirements of this specification. No contractor shall knowingly employ, hire for employment, or continue to employ an unauthorized alien to perform work within the State of Missouri. Vendor and any of its subcontractors, shall, by sworn affidavit and provision of documentation, affirm their enrollment and participation in a federal work authorization program with respect to the employees working in connection with the contracted services. Vendor and its subcontractors shall also sign an affidavit affirming that they do not knowingly employ any person who is an unauthorized alien.

Prevailing Wage Vendor and its subcontractors shall pay not less than the prevailing hourly rates of wages, as determined by the Labor and Industrial Relations Commission of Missouri. Vendor shall abide by the most current Annual Wage Order published by the Missouri Department of Labor and Industrial Relations or other similar resources and publications. Failure to comply with any provision, provide any required documentation, insurance forms or deposits or bonds in exact amounts or any other term or condition that is not in strict conformance shall result in the bid being rejected.

**B. BASIS OF PROPOSAL AWARD:**

Award may be made on an item-by-item basis to the lowest and best proposals or award may be made to the lowest and best proposal total, whichever is in the best interest of the County. County may reject any or all proposals for any reason and may waive any informality. Proposals submitted from a Missouri State Contract shall include a copy of the State Contract with the proposal.

It is further agreed that the Contract shall not be valid and binding upon the County until approved by the County Counselor, as to legal form and is subject to the Ordinances, Resolutions and Orders of Jefferson County, Missouri, and State and Federal Law. If no proposal or proposals have been awarded by the County Council within forty-five (45) days following the opening of the proposal then all proposals will be deemed rejected.

**C. PROPOSAL PREPARATION:**

1. Vendors are responsible for examination of drawings, specifications, schedules and instructions.
2. Each Vendor shall furnish the information required by the invitation. The vendor shall sign all required documents. All deletions and erasures shall be initialed
3. Alternate proposals for supplies or services other than specified shall not be considered unless authorized by invitation.
4. Vendor shall state a definite time for delivery of goods or for performance of services unless otherwise specified in the Request for Proposal.
5. When specified, samples must be timely submitted and at no expense to the County.
6. Failure to adhere to all requirements may result in the response being disqualified as non-responsive.

**D. MODIFICATION OR WITHDRAWAL OF PROPOSALS:**

Proposals may be modified or withdrawn prior to the exact hour and date specified for receipt of proposals, provided the modification or withdrawal is in writing and is delivered in the same manner as a proposal submission.

**E. LATE PROPOSALS:**

It is the responsibility of the vendor to deliver his proposal or proposal modification on or before the date and time of the proposal closing to the Department of the County Clerk of Jefferson County. Proposals received late will be rejected and returned unopened to the vendor.

**F. BID DEPOSITS/BONDS:**

Bid Deposits/Bonds are not required unless specified in the specifications. Bid deposits/Bonds must be in the exact amount as stipulated in the bid.

Bid Guaranty: The bidder shall submit a Bid Guaranty. The project bid bond form is included in the bid book. The bidder shall mark the box below to identify the type of Bid Guaranty.

- ☒ Paper Bid Bond  
☐ Cashier's Check

Bid Guaranty shall be made payable to the Owner, in the amount of five percent of the Bidder's maximum Bid price and in the form of a certified or bank check or a Bid Bond (on form attached, if a form is prescribed) issued by a Surety.



The Bid security of the Successful Bidder will be retained until such Bidder has executed the Agreement and furnished the required Contract Security within 15 days of the Notice of Award. Failure to do so may result in the annulment of the Notice of Award and forfeiture of the Bid Security. The Bid Security of any Bidder whom the Owner believes to have a reasonable chance of receiving the award, may be retained by the Owner until the earlier of the seventh day after the "effective date of the Agreement" (which is the date when the agreement has been executed by all parties) by Owner to Contractor and the required Contract Security is furnished or the sixty-first day after the Bid opening. Bid Security of other Bidders will be returned within seven days of the Bid opening.

**G. MATERIAL AVAILABILITY:**

Vendors must accept responsibility for verification of material availability, product schedules and other pertinent data prior to submission of proposal and delivery time. It is the responsibility of the vendor to notify the County immediately if the materials specified are discontinued, replaced, or not available for an extended period of time. All materials ordered by the County, shall be as needed. A sample of materials may be requested.

**H. ALTERNATE PROPOSALS:**

Where required, vendors must submit complete specifications on all alternate proposals with the proposal form. Alternate proposals without complete specifications may be rejected. Alternate proposals and exceptions to proposal clauses must be clearly noted on the proposal form. The County may accept or reject alternate proposals; whatever is most advantageous to the County.

**I. INCORPORATION OF DOCUMENTS:**

The terms of the proposal invitation, proposal specifications, proposal form are and shall be incorporated into the contract as if fully setout therein. The Proposal, if accepted and approved by the County Council and County Executive shall constitute the terms of a Contract or Agreement with Jefferson County, Missouri, subject to any further Amendments, Memoranda or other documents or specifications which must be set forth in writing and signed by all parties.

**J. ADDENDA:**

Addenda to proposal specifications are incorporated by reference as if fully setout herein. It is the responsibility of the vendor to insure and verify that they are in receipt of and completed all attached addenda's prior to submission of proposal forms. Verification is made by contacting the Department of Administrative Services or by reviewing the County Web Site. ([www.jeffcomo.org](http://www.jeffcomo.org)).

**K. INSURANCE:**

The Vendor/Contractor shall purchase and maintain insurance with an insurance company licensed to do business in the State of Missouri or in the state where the vendor is incorporated or otherwise licensed to do business and which shall remain, at all times during the term of any contract with the County, in full force and effect. Preference will be given to a Vendor/Contractor who provides insurance with an insurance company licensed to do business in the State of Missouri, but in any event said Vendor/Contractor shall provide said insurance at it's own expense. Such insurance shall be provided as will protect the Vendor/Contractor from claims which may arise out of or result from the Vendor/Contractor's execution of the work, whether such execution be by himself, his employees, agents, or by anyone for whose acts any of them may be liable. If any such work covered by the Contract is to be performed on County owned or leased premises, the Vendor agrees to carry liability and workman's compensation insurance, satisfactory to the County, and to indemnify the County against all liability, loss, and damage arising out of any injuries to persons and property caused by the Vendor, his sub-contractors, employees or agents. The insurance coverage shall be such as to fully protect the County and the general public from any and all claims for injury and damage resulting by any actions on the part of the Vendor/Contractor or its' forces as enumerated above. All policies must name the County as an additional insured and provide for thirty (30) days written prior to any material changes or cancellation. Any disputes regarding a breach, insurance amounts, liability, coverage, lapse or otherwise shall be litigated in the Circuit Court of Jefferson County, Missouri and the same shall be incorporated into any Contract agreed to by the parties.

THE COUNTY REQUIRES A CURRENT AND VALID CERTIFICATE OF INSURANCE OR BINDER SHOWING REQUIRED INSURANCE COVERAGE MUST BE PROVIDED WITH EACH BID. JEFFERSON COUNTY MUST BE ADDED AS AN ADDITIONAL INSURED AFTER AWARD OF THE BID. ANY LAPSE IN INSURANCE COVERAGE OR CANCELLATION THEREOF BY THE CONTRACTOR OR SUB-CONTRACTORS DURING THE TERMS OF THE CONTRACT SHALL IMMEDIATELY BE DEEMED A MATERIAL BREACH UNDER THE TERMS OF ANY CONTRACT.

A. ☒ Required ☐ Not Required **Comprehensive General Liability Insurance**

The Vendor/Contractor shall maintain and keep in full force and effect during the terms of this Contract such comprehensive general liability insurance as shall protect them from claims which may arise from operations under this Contract, whether such operations be by themselves or by anyone directly or indirectly employed by them. The amounts of insurance shall be not less than \$1,000,000.00 combined single limit for any one occurrence covering both bodily injury and property damage, including accidental death.

B. ☒ Required ☐ Not Required **Professional Liability Insurance**

The Vendor/Contractor shall provide the County with proof of Professional Liability Insurance, which shall protect the County against any and all claims, which might arise as a result of the operation of the Vendor/Contractor in fulfilling the terms of this Contract during the life of the Contract. The minimum amounts of such insurance will be \$1,000,000.00. Should any work be subcontracted, these limits will also apply.

- C. (X) Required ( ) Not Required **Worker's Compensation Insurance:**  
per Missouri Revised Statutes Chapter 287

The Vendor/Contractor or his sub-contractor or contractors, shall maintain and keep in force of this Contract such worker's compensation insurance limits as required by the statutes of the State of Missouri and Employer's Liability with limits no less than \$500,000.00.

**L. PROPOSAL OPENINGS:**

Proposals will be publicly opened and read aloud at the time indicated on page 1. The vendors and the public are invited but not required to attend the formal opening of the proposals. No decisions relating to the award of a contract or agreement will be made at the opening.

**M. PROPOSAL TABULATIONS:**

Proposal Tabulations will be available 5 to 7 business days following the proposal opening. Proposal submissions are open for public review at the time of the proposal opening. Proposal tabulations are posted on the County's web-site address, [www.jeffcommo.org](http://www.jeffcommo.org), under the services tab, Invitation for Bid/Request for Proposal link. **NO COPIES** of proposal tabulations are sent to vendors.

**PROPOSAL FORM AND CONTRACT**

**A. PROPOSAL REPRESENTATIONS:**

The vendor, by executing the proposal form certifies that:

1. The proposal complies with Request for Proposal, Form and Proposal Specifications.
2. The vendor is not debarred or suspended from participation in Federal Assistance programs.

**B. TAXES:**

No bid or proposal shall be awarded by Jefferson County unless the prospective bidder provides proof that the bidder does not owe delinquent real or personal property taxes to Jefferson County. The prospective bidder may be required to provide proof in the form of an original paid tax receipt issued by the Jefferson County Collector or a verified affidavit stating that the applicant does not own any real or personal property in Jefferson County. Tax receipts for the past 3 years are required and may be obtained at <http://jeffersonmo.devnetwedge.com/> or a notarized affidavit stating that the applicant does not own any real or personal property in Jefferson County on company letterhead.

Section 135.040 of the Jefferson County Code of Ordinances (Ord. No. 10-0411) requires that no bid or proposal shall be awarded by Jefferson County unless the prospective bidder provides proof that the bidder does not owe delinquent real or personal property, or that the bidder does not own any real or personal property in Jefferson County. All delinquent real or personal property taxes shall be paid, in-full, prior to the award of any bid, or proof shall be provided that the bidder does not own any real or personal property in Jefferson County prior to the award of any bid. Jefferson County considers that the failure to pay any and all real or personal property taxes due Jefferson County, Missouri, the failure to report all real or personal property owned, held or used in Jefferson County, the failure to provide proof thereof, and/or the failure to keep said tax bills current shall be deemed a material breach of the contract and will subject the contract to immediate cancellation. All taxes, due and owing, must be paid in full at the time the bid is awarded by Jefferson County and remain paid during the entire term of the contract unless the prospective bidder provides proof that the bidder does not own real or personal property in Jefferson County. This requirement shall not apply to the award of bids for projects which are funded in whole or in part by Federal funds.

**C. CERTIFICATION OF INDEPENDENT PRICE DETERMINATION:**

1. The prices in the proposal shall be independently determined, without consultation, communication, or agreement for the purpose of restricting competition as to any matter relating to price with any Vendor or other person.
2. Unless otherwise required by law, the prices shall not have been knowingly disclosed by the Vendor prior to opening; or
3. No attempt has been made or will be made by the vendor to induce any other person or firm to submit or not to submit a proposal.

**D. PRICE:**

The price(s) specified in this proposal shall be firm and not subject to contingency or reservation. The vendor represents prices specified in the proposal do not exceed current selling price for the same or substantially similar good or service, and are the same as or lower than other prices charged to the vendor's most favored customer. In the event the stated prices are determined to be higher than the prices for which Supplier has sold the items, or services, to others, this contract price shall be reduced accordingly. **Proposal prices are ALL INCLUSIVE: (Shipping, Handling, Delivery, and Assembly to locations specified by the County). Prices shall be firm for ALL County departments and locations for term of the agreement.**

**E. MISSOURI DOMESTIC PRODUCT PROCUREMENT ACT:**

Vendor represents that the goods provided comply with Sections 34.350 to 34.359, RSMo, known as the Domestic Product Procurement Act. The act encourages the purchase of products manufactured or produced in the United States, State of Missouri, and Jefferson County, Missouri. Vendor shall include proof of compliance with the Act with the proposal.

**F. NON-EXCLUSIVE AGREEMENT:**

The contractor shall understand and agree that the contract shall not be construed as an exclusive agreement and further agrees that the County may secure identical and/or similar services or products from other sources at anytime in conjunction with or in replacement of the contractor's services.

**G. DEFINITIONS:**

1. The term "County" means the Jefferson County, Missouri and its designated representatives.
2. The term "Vendor" means Supplier, Contractor, and Seller and includes designated representatives.
3. The term "RFP" means Request for Proposal.
4. The term "Agreement/Contract" means Binding Agreement, Contract, Request for Purchase, Order.

**H. INSPECTION, ACCEPTANCE AND APPROVALS:**

Goods shall at all times and places, including the period of manufacture, are subject to inspection and test by County. County will accept or give notice of rejection of goods delivered within a reasonable time after receipt. Acceptance shall not waive any warranty. All goods supplied are subject to final inspection and acceptance by County notwithstanding payment, prior inspections or approvals. County may require prompt replacement or correction of rejected goods at Supplier's expense, including a reduction in price for rejected goods. Supplier shall not resubmit rejected goods to County without prior written approval and instructions from County. In addition, Supplier shall identify resubmitted goods as previously rejected. Supplier shall provide and maintain a quality assurance and control system acceptable to County.

**I. WARRANTY:**

Unless otherwise agreed to in writing by the parties, Supplier warrants that items ordered to specifications will conform thereto and to any drawings, samples or other descriptions furnished or adopted by County, or, if not ordered to specifications will be fit and sufficient for the purpose intended, and that all items will be new, merchantable, of good material and workmanship, and free from defect. Such warranties, together with Supplier's service warranties and guarantees, if any, shall survive inspection, test, acceptance of, and payment for the items and shall run to County and its assigns. Except for latent defects, the County shall give notice of any nonconformity to the Supplier within one (1) year after acceptance. County may return for credit or require prompt correction or replacement of the defective or non-conforming goods or have the defective good corrected or replaced at Supplier's expense. Return to Supplier of any defective or non-conforming goods and delivery to County of any corrected or replaced goods shall be at Supplier's expense. Defective or non-conforming items shall not be corrected or replaced without written authorization by County. Goods required to be corrected or replaced shall be subject to the provisions of this clause and the clause hereof entitled "Inspection, Acceptance and Approvals" in the same manner and to the same extent as goods originally delivered under this contract.

**J. PAYMENT:**

County will pay Supplier for goods upon delivery to, submission of certified invoices and acceptance. The County will not be responsible for articles or services furnished without a purchase order. Price is tax-exempt.

**K. CHANGE ORDER:**

County may make changes within the general scope of this contract. If any such changes cause an increase or decrease in the cost of or the time required for the performance of any part of the work, whether changed or not changed by any such order, an equitable adjustment shall be made in the price or delivery schedule or both, and any change order shall be in writing. Any claim by a Supplier for adjustment under this clause shall be asserted within fifteen (15) days from the date of receipt of this written order directing the change, provided, however, County, if it decides that the facts justify such action, may receive and act upon such claim asserted at any time prior to final payment.

**L. DELIVERIES:**

Deliveries shall be made in strict accordance with any delivery schedule contained in the proposal specification or contract and in the exact quantity ordered. Failure to adhere to delivery schedule is reason for termination in accordance with the "termination" clause. Deliveries are to be made at locations specified by the County at time of Order.

**M. RESPONSIBILITY FOR SUPPLIES:**

Pursuant to Section 290.560 RSMo, Supplier/Contractor shall employ only Missouri laborers and laborers from nonrestrictive states except that other laborers may be used when Missouri laborers or laborers from nonrestrictive states are not available, or are incapable of performing the particular type of work involved, if so certified by the contractor and approved by the County. Except as otherwise provided, Supplier shall be responsible and bear all risks for loss and damage to goods until delivery at County's facilities, regardless of F.O.B. point, point of inspection or acceptance; and if the goods are rejected.

**N. SUBCONTRACTS:**

Supplier shall not enter into any subcontract(s) in excess of \$25,000 or 20% of this contract price; whichever is less, for any goods without County's prior written approval.

**O. CHOICE OF LAW:**

This proposal and contract shall be governed and interpreted according to the laws of the State of Missouri. Venue for any court action shall be in Jefferson County, Missouri.

**P. TERMINATION:**

1. General: Performance of work may be terminated by the County in whole, or from time to time in part, whenever County shall determine that such termination is in the best interests of County. Termination shall be affected by delivery to Supplier of a Notice of Termination specifying the extent to which performance of work is terminated and the date upon which such termination becomes effective. If such notice does not state termination is pursuant to subparagraph 2, 3, or 4 of this paragraph, County shall have the right to so indicate within thirty (30) days. If no notice is delivered within the thirty (30) day period, or such longer periods as is mutually agreed to by the parties, the original Notice of Termination shall be deemed to be issued pursuant to subparagraph 1 of this paragraph.
2. Bankruptcy or Insolvency: In the event bankruptcy proceedings are commenced by or against Supplier or under any provisions of the United States Bankruptcy Act or for the appointment of a receiver or trustee or a general assignment for the benefit of creditors of either party, County shall be entitled to terminate without further cost or liability.
3. Section 135.040 of the Jefferson County Code of Ordinances (Ord. No. 10-0411) requires that no bid or proposal shall be awarded by Jefferson County unless the prospective bidder provides proof that the bidder does not owe delinquent real or personal property, or that the bidder does not own any real or personal property in Jefferson County. All delinquent real or personal property taxes shall be paid, in-full, prior to the award of any bid, or proof shall be provided that the bidder does not own any real or personal property in Jefferson County prior to the award of any bid. Jefferson County considers that the failure to pay any and all real or personal property taxes due Jefferson County, Missouri, the failure to report all real or personal property owned, held or used in Jefferson County, the failure to provide proof thereof, and/or the failure to keep said tax bills current shall be deemed a material breach of the contract and will subject the contract to immediate cancellation. All taxes, due and owing, must be paid in full at the time the bid is awarded by Jefferson County and remain paid during the entire term of the contract unless the prospective bidder provides proof that the bidder does not own real or personal property in Jefferson County. This requirement shall not apply to the award of bids for projects which are funded in whole or in part by Federal funds.
4. Default: County may terminate the whole Contract or any part in either of the following circumstances:
  - a. If supplier fails to deliver the items required by the contract within the time specified; or
  - b. If supplier fails to perform any of the other provisions of the contract, or so fails to make progress as to endanger performance of the contract in accordance with its terms, and in either of these two circumstances does not cure such failure within a period of ten (10) days after notice from County specifying such failure. In the event of termination under subparagraph 1, County shall have the right to procure, on such terms and in such manner as it may deem appropriate, items similar to those terminated, and to recover from Supplier the excess cost for such similar items provided, however, Supplier shall not be liable for such excess costs where the failure upon which the termination is based has arisen out of causes beyond the control of Supplier and without the fault or negligence of Supplier. Such causes shall be deemed to include fires, floods, earthquakes, strikes, and acts of the public enemy. The rights of County provided in subparagraph 1 shall be in addition to any other rights provided by law or the contract.
  - c. In the event of the Supplier's non-compliance with the provisions as set forth. This Contract may be cancelled, terminated or suspended in whole or in part and the supplier may be declared ineligible for further County contracts. The rights and remedies of the County provided in this paragraph shall not be exclusive but are in addition to any remedies provided in this Contract or as provided for by law.

**Q. NOTICE AND SERVICE THEREOF:**

Any notice from the County shall be in writing and considered delivered and the service thereof completed when said notice is posted, by certified or regular mail, to the Supplier, at the address stated on the proposal form.

**R. CONTRACT TERM:**

Performance shall be governed solely by the terms and conditions as set forth in the Request for Proposal, Proposal Specifications, Proposal Form and the Contract notwithstanding any language contained on any invoice, shipping order, bill of lading or other document furnished the Seller at any time and the acceptance by the County for any goods furnished.

**S. COMPLIANCE WITH APPLICABLE LAWS:**

Supplier warrants it has complied with all applicable laws, rules and ordinances of the United States, Missouri or any other Governmental authority or agency in the manufacture or sale of the goods, including but not limited to all provisions of the Fair Labor Standards Act of 1938, as amended, including provisions of the Home Rule Charter of Jefferson County, Missouri requiring all workers performing work under any contract with Jefferson County be paid a wage that is at least the prevailing hourly rate of wages for work of a similar character in Jefferson County and shall be paid to all workers performing work under the contract. (Section 290.250 and 290.325, RSMo).

- A. The contractor will forfeit a penalty to the contracting public body of \$100 per day (or portion of a day) for each worker that is paid less than the prevailing rate for any work done under the contract by the contractor by any subcontractor." (Section 290.250, RSMo). For detailed information on rules and occupational titles, see 8 CSR 30-3.010 through 3.060.
- B. The contractor and all subcontractors to the contract must require all onsite employees to complete the ten-hour construction safety training program and have documentation of having done so.
- C. The contractor will forfeit a penalty to the contracting public body of \$2500 plus an additional \$100 for each employee employed by the contractor or subcontractor, for each calendar day, or portion thereof, such employee is employed without the required training. (Section 292.675 RSMo).
- D. Before any work begins, you must send a **Prevailing Wage Project Notification – Contractor Information Notification** form (PW-2) to the DLS. Send it when the contract is awarded to ensure the DLS receives it timely (Section 290.262.10, RSMo, and 8 CSR 30-3.010(3)).
- E. If a wage subsidy, bid, or rebate was provided, the supplement or rebate **must** be reported to the public body within 30 days of receipt of payment (Section 290.095, RSMo). Notification should be reported to:

Contracts and Grants  
County of Jefferson  
PO Box 100  
Hillsboro, MO 63050-0100

**T. ACTS OF GOD:**

No party shall be liable for delays, nor defaults due to Acts of God or the public enemy, riots, strikes, fires, explosions, accidents, governmental actions of any kind or any other causes of a similar character beyond its control and without its fault or negligence.

**U. SELLER'S INVOICES:**

Invoices shall contain the following information. Contract number (if any), Purchase Order Number, Item number, contract description of goods or services, sizes, quantities, unit prices and extended totals. Invoices for and inquiries regarding payment should be addressed to the County Accounts Payable Clerk.

**V. APPROVAL:**

It is agreed the acceptance of a proposal shall not be valid and binding upon the County until approved by the County Purchasing Agent, County Council and County Counselor.

**W. INDIVIDUAL, PARTNERSHIPS, CORPORATIONS:**

Indicate: ☐ Individual: ☐ Partnership: ☒ Corporation.

Incorporated in the State of MO

**X. LITIGATION:**

This agreement shall be interpreted under the laws of the State of Missouri. Any disagreements, questions, controversies, litigation or other causes of action whatsoever arising from or under the terms of this agreement shall be resolved in the trial courts of 23rd Judicial Circuit Court of the State of Missouri-Hillsboro, Missouri.

**Y. LANGUAGE:** Bids and all related documents will only be accepted in the English Language.

THE INVITATION FOR BID / REQUEST FOR PROPOSAL NOTICES ARE POSTED ON THE JEFFERSON COUNTY, MISSOURI WEBSITE AT WWW.JEFFCOMO.ORG LOCATED UNDER THE SERVICES TAB, INVITATION FOR BID / REQUEST FOR PROPOSAL LINK.

**SPECIFICATION**  
**CONTACT**

**KERRY ROGERS – FACILITIES DEPARTMENT - 636 797 5011**

### AFFIDAVIT OF WORK AUTHORIZATION

The grantee, sub grantee, contractor or subcontractor who meets the section 285.525, RSMo definition of a business entity must complete and return the following Affidavit of Work Authorization.

Comes now Edward Boyer (Name of Business Entity Authorized Representative) as  
President (Position/Title) first being duly sworn on my oath, affirm  
EA Boyer Bldg & Design, Inc (Business Entity Name) is enrolled and will continue to participate in the  
E-Verify federal work authorization program with respect to employees hired after enrollment in the program  
who are proposed to work in connection with the services related to Recorder's Office Remodel  
(Bid/Grant/Subgrant/Contract/Subcontract) for the duration of the grant, subgrant, contractor, or subcontractor,  
if awarded in accordance with subsection 2 of section 285.530, RSMo. I also affirm that  
EA Boyer Bldg & Design, Inc (Business Entity Name) does not and will not knowingly employ a person  
who is an unauthorized alien in connection with the contracted services related to  
Recorder's Office Remodel (Bid/Grant/Subgrant/Contract/Subcontract) for the duration of  
the grant, subgrant, contract, or subcontract, if awarded.

*In Affirmation thereof, the facts stated above are true and correct. (The undersigned understands that false statements made in this filing are subject to the penalties provided under section 575.040, RSMo.)*

Edward Boyer  
Authorized Representative's Signature

Edward Boyer  
Printed Name

President  
Title

1/24/2017  
Date

Subscribed and sworn to before me this 24 of January 2017. I am  
(DAY) (MONTH, YEAR)

commissioned as a notary public within the County of Jefferson, State of  
(NAME OF COUNTY)

MO, and my commission expires on 1/20/20.  
(NAME OF STATE) (DATE)

Stephanie M. Furtado  
Signature of Notary

1/24/2017  
Date

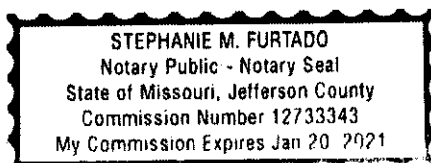

## AFFIDAVIT OF WORK AUTHORIZATION

(Continued)

### CURRENT BUSINESS ENTITY STATUS

I certify that EA Boyer Bldg & Design, Inc (Business Entity Name) **MEETS** the definition of a business entity as defined in section 285.525, RSMo pertaining to section 285.530, RSMo as stated above.

Edward Boyer  
Authorized Business Entity  
Representative's Name  
(Please Print)

Edward Boyer  
Authorized Business Entity  
Representative's Signature

EA Boyer Bldg & Design, Inc  
Business Entity Name

1/24/2017  
Date

As a business entity, the grantee, sub grantee, contractor, or subcontractor must perform/provide the following. The grantee, sub grantee, contractor, or subcontractor shall check each to verify completion/submission:

- ☐ Enroll and participate in the E-Verify federal work authorization program  
(Website: <http://www.dhs.gov/e-verify>;  
Phone: 888-464-4218; Email: [e-verify@dhs.gov](mailto:e-verify@dhs.gov)) with respect to the employees hired after enrollment in the program who are proposed to work in connection with the services required herein;

AND

- ☐ Provide documentation affirming said company's/individual's enrollment and participation in the E-Verify federal work authorization program. Documentation shall include a page from the E-Verify Memorandum of Understanding (MOU) listing the grantee's, subgrantee's, contractor's, or subcontractor's name and the MOU signature page completed and signed, at minimum, by the grantee, subgrantee, contractor, or subcontractor and the Department of Homeland Security – Verification Division; (if the signature page of the MOU lists the grantee's, subgrantee's, contractor's, or subcontractor's name, then no additional pages of the MOU must be submitted).

## SPECIFICATIONS

The Request of Proposal shall be for Jefferson County Recorder's Office Remodel of Customer Service Area.

All questions for this project shall be addressed to

Mr. Kerry Rogers  
Facilities Services Supervisor  
PO BOX 100  
Hillsboro MO 63050

Email address: [kr Rogers@jeffcomo.org](mailto:kr Rogers@jeffcomo.org)  
Phone: 636-797-5011  
Cell Phone: 314-775-6458



# Interior Remodeling of Existing Building; Add Dividing Glass at Existing Customer Ser- vice Counter; Office of the Recorder Hillsboro, MO

Public Works Project

No.:

## List of Drawings:

- C-1 COVER, GENERAL NOTES
- A-1 FLOOR PLAN, INTERIOR ELEVATIONS
- A-2 SPECIFICATIONS

## GENERAL PROJECT NOTES:

- 1) DO NOT SCALE DRAWINGS. FOLLOW WRITTEN DIMENSIONS ONLY. FOR CRITICAL DIMENSIONS NOT SHOWN IN THE DRAWINGS, CONTACT THE ARCHITECT.
- 2) THESE DRAWINGS ARE ACCOMPANIED BY SPECIFICATIONS. DO NOT RELY SOLELY ON THE DRAWINGS FOR DIMENSIONS. TEST IMMEDIATELY OF ANY CONFLICTS BETWEEN THE TWO. IF NO TIMELY RESPONSE IS RECEIVED FROM THE ARCHITECT, ASSUME THE MORE EXPENSIVE OR MORE RESTRICTIVE CONDITION WILL PREVAIL.
- 3) SITE AND/OR EXISTING CONDITIONS DRAWINGS ARE BASED ON CASUAL OBSERVATIONS. THE ARCHITECT MAKES NO GUARANTEE OF THE ACCURACY OF THESE DRAWINGS. ANY CONDITIONS ON THE SITE WHICH ARE AT VARIANCE WITH THE DRAWINGS OR SPECIFICATIONS.
- 4) DO NOT CUT OR MODIFY ANY STRUCTURAL ITEM WITHOUT FIRST REVIEWING THE PROPOSED MODIFICATION WITH THE ARCHITECT AND OBTAINING A PLAN FOR ANY TEMPORARY SHORINGS NECESSARY.
- 5) ALL MATERIALS SHALL BE NEW AND INSTALLED TO MANUFACTURER'S WRITTEN SPECIFICATIONS.
- 6) PROVIDE ALL NECESSARY BARRIERS AND SAFETY SIGNALS NECESSARY FOR A SAFE WORK ENVIRONMENT. CONFORM TO ALL LOCAL, COUNTY, STATE AND FEDERAL REQUIREMENTS WHICH APPLY.
- 7) WHERE AN ITEM OR SYSTEM IS SHOWN TO BE INCLUDED IN THE WORK, IT SHALL BE COMPLETELY OPERABLE, COMPLETELY COMPLIANT WITH ALL CODES, ALL CONNECTIONS, SWITCHING, POWER, VENTILATION AND ANY OTHER ACCESSORIES NECESSARY TO PROVIDE A COMPLETE, OPERABLE ITEM OR SYSTEM.
- 8) COMMENCING INSTALLATION OF ANY ITEM, EQUIPMENT OR SYSTEM INDICATES COMMENCEMENT OF THE WORK. THE CONTRACTOR SHALL BE RESPONSIBLE FOR THE PROTECTION OF THE CONDITION UPON WHICH THE SUBSEQUENT CONSTRUCTION IS DEPENDENT OR ATTACHED TO OR SUPPORTED ON. FOR EXAMPLE, BEGINNING FLOORING INSTALLATION REPRESENTS ACCEPTANCE OF THE SUB FLOOR CONSTRUCTION AND/OR PREPARATION.
- 9) THE PLANNED WORK DOES NOT INCLUDE MOVING OR RELOCATING ANY EXISTING EQUIPMENT OR SYSTEMS. THE CONTRACTOR SHALL LAY OUT THE WORK AND VERIFY NO INTERFERENCE WITH EXISTING BUILDING SYSTEMS OR COMPONENTS.

## BUILDING CODE REVIEW:

- 1) ALL WORK OF THIS PROJECT SHALL CONFORM TO THE 2009 INTERNATIONAL CODE CONVENTS INC. AS INTERPRETED BY THE LOCAL AUTHORITY HAVING JURISDICTION OVER COMMERCIAL CONSTRUCTION.
- 2) DURING THE PLANNING OF THIS WORK, THE ARCHITECT HAS REVIEWED THE BUILDING UNDER MAKE HAS AWARE OF ANY EXISTING, NON-COMPLYING CONDITION REQUIRING CORRECTION.
- 3) THIS PROJECT INCLUDES ONLY ALTERATIONS TO THE EXISTING INTERIOR SPACES, IE, THE ADDITION OF TEMPERED GLASS DIVIDERS ON THE EXISTING SERVICE COUNTERS OF THE RECORDER'S OFFICE.
- 4) THIS WORK DOES NOT CHANGE ANY EXISTING EXTINGUISHERS OR TO THE OCCUPANT LOAD OF ANY SPACE. CHANGES TO EXISTING EXTINGUISHERS OR TO THE OCCUPANT LOAD OF ANY SPACE SHALL BE THE RESPONSIBILITY OF THE CONTRACTOR. ANY EXISTING AUTO FIRE PREVENTION SYSTEMS, NOR INTERFERE WITH ANY EXISTING ELECTRICAL OR MECHANICAL SYSTEM IN PLACE.

JEFFERSON CO.  
(MISSOURI)  
PUBLIC WORKS  
DEPARTMENT  
Jason Jonas, P.E.  
Director

Signature / Date

COMMISSION  
NUMBER  
15-122  
DRAWN BY mjb  
CHECKED BY sfb  
DATE 11/25/16

Final Plans for  
Bidding & Con-  
struction, with  
Building Permit

PLAN STATUS



Steven J. Bacon  
Architect  
MO Lic: #007402



BACON  
COMMERCIAL  
DESIGN LLC  
ARCHITECTURAL  
DESIGN and  
CONSULTING  
PO BOX 605  
Hillsboro, MO 63050  
(636) 933-0007  
corporate authority  
certificate # 2005007256

Jefferson County  
Recorder's Office

Remodel  
Customer  
Service Area

Jefferson County  
Administration Ctr  
729 Maple  
Hillsboro, MO 63050

COMMISSION

Cover,  
Gen. Notes

SHEET TITLE

SHEET  
NUMBER

C-1  
OF 1

COMMISSION  
NUMBER  
**15-122**  
DRAWN BY mjb  
CHECKED BY sjb  
DATE 11/25/16

Final Plans for  
Bidding & Con-  
struction, with  
Building Permit

PLAN STATUS



Steven J. Bacon  
Architect  
MO Lic: #007402



**BACON  
COMMERCIAL  
DESIGN LLC**  
ARCHITECTURAL  
DESIGN and  
CONSULTING  
PO BOX 685  
JEFFERSON CITY  
MO 63019  
(636) 933-0007  
corporate authority  
certificate #: 2005007260

Jefferson County  
Recorder's Office  
Remodel  
Customer  
Service Area  
Jefferson County  
Administration Ctr  
729 Maple  
Hillsboro, MO 63050  
**COMMISSION**

**Floor Plan &  
Interior Elevs**

SHEET TITLE  
SHEET  
NUMBER  
**A-1**  
OF 2

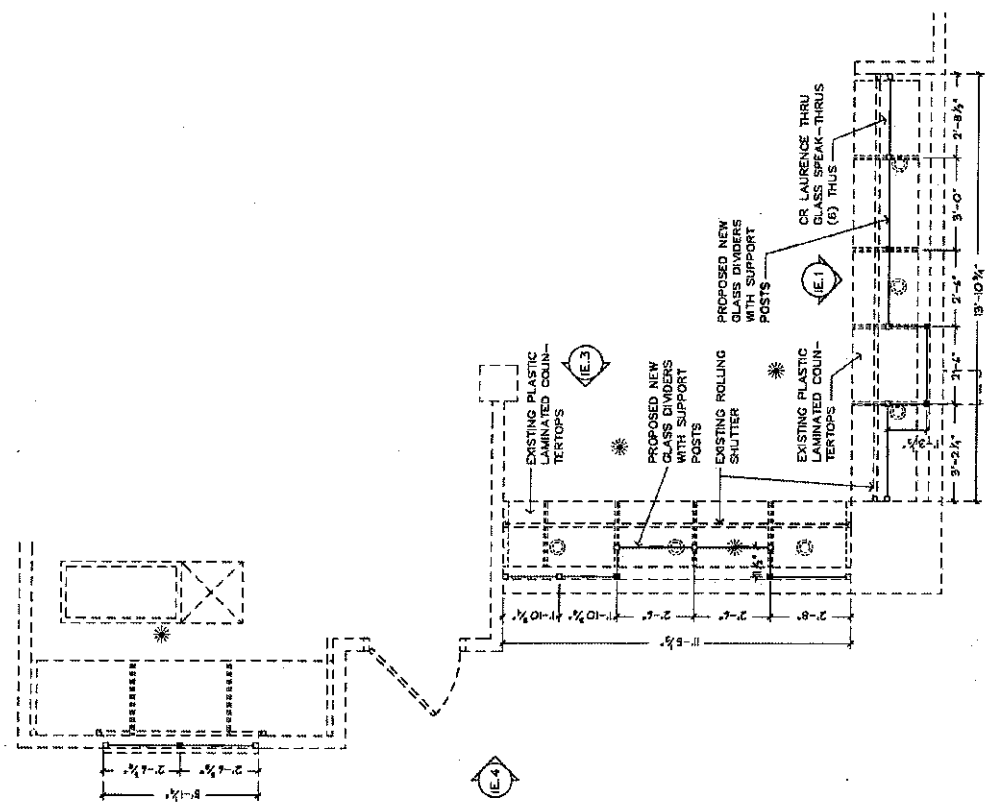

**D. FLOOR PLAN -- ASSESSOR'S OFFICE**  
SCALE: 3/8" = 1'-0"

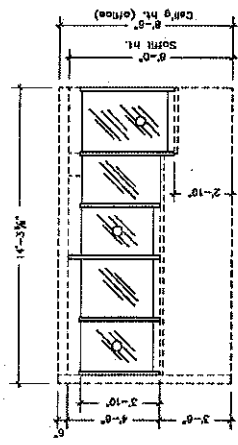

**(E.1) INTERIOR ELEVATION--OFFICE**  
SCALE: 1/4" = 1'-0"

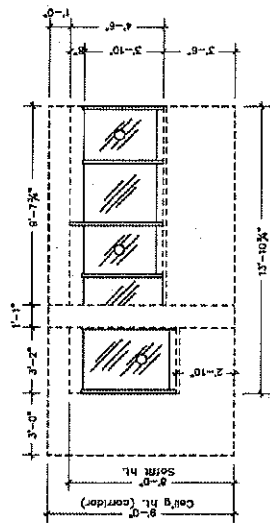

**(E.2) INTERIOR ELEVATION--CORRIDOR**  
SCALE: 1/4" = 1'-0"

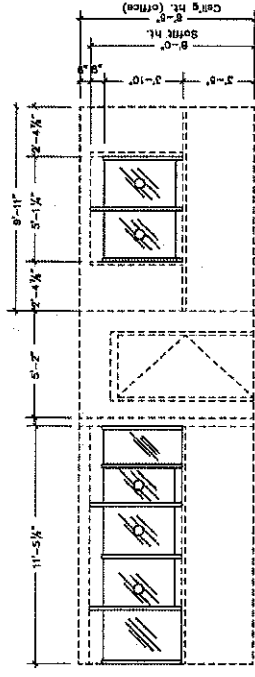

**(E.3) INTERIOR ELEVATION--OFFICE**  
SCALE: 1/4" = 1'-0"

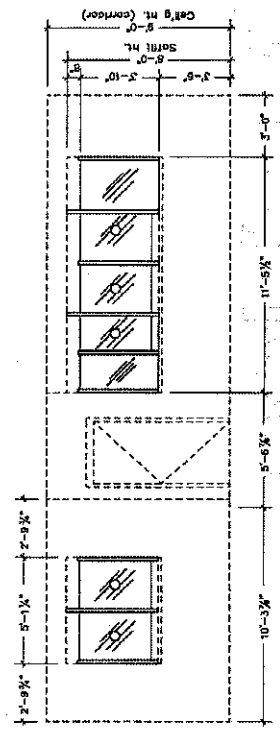

**(E.4) INTERIOR ELEVATION--CORRIDOR**  
SCALE: 1/4" = 1'-0"

Prepared for Project

**Final Plans for  
Bidding & Con-  
struction, with  
Building Permit**

**PLAN STATUS**



**Steven J. Bacon  
Architect  
MO Lic: #007402**

**BACON  
COMMERCIAL  
DESIGN LLC  
ARCHITECTURAL  
DESIGN AND  
CONSULTING**  
PO Box 805  
Jefferson County  
Missouri 63001  
(636) 933-0007  
certificat e: 2009007590

**Jefferson County  
Recorder's Office**

**Remodel  
Customer  
Service Area**

**Jefferson County  
Administration Ctr  
729 Maple  
Hillsboro, MO 63050**

**COMMISSION**

**Specifications**

**SHEET TITLE**  
**SHEET**  
**NUMBER**  
**A-2**  
**OF 2**

**SPECIFICATIONS:**

- SECTION 05 7800  
STAINLESS STEEL GLASS CLAMP POSTS**
- 1.01 GENERAL**
- A. Section Includes**
1. ANSI A971 Safety Performance Specifications and Methods of Test for Safety Glazing Material
  2. Manufacturer (NAMA) and National Ornamental and Miscellaneous Metals Association (NOMMA)
- 1.02 SUBMITTALS**
1. Submit shop drawings and product data under provisions of Section 05 000 Administrative Requirements.
  2. Shop drawings and product data.
  3. Indicate all required field measurements.
  4. Indicate component details, materials, finishes, connection and joining methods, and the relationship to adjoining work.
- B. Product Data:** Manufacturer's specifications and technical data including the following:
1. Material specification of construction and installation.
  2. Manufacturer's installation instructions.
- 1.03 QUALITY ASSURANCE**
- A. Installer's Qualifications:** Firm with demonstrated experience in installation of systems similar in complexity to those required for this project.
- B. Manufacturer's Qualifications:**
1. Components and installation are to be in accordance with state and local code authorities.
  2. Certification:
- C. Certifications:**
1. Furnish certification that all components and fittings are furnished by the same manufacturer or approved by the primary component manufacturer.
- 1.04 DELIVERY, STORAGE, AND HANDLING**
- A. Delivery:** Deliver to project location in a condition and properly protected against damage to finished surfaces.
- B. Storage on site:**
1. Store material in a location and in a manner to avoid damage. Stacking shall be done in a way that will prevent bending, dry location away from unsecured concrete and masonry.
  3. Keep handling on site to a minimum. Exercise particular care to avoid damage to finishes of material.
- PART 2 - PRODUCTS**
- 2.01 MANUFACTURERS**
1. Stainless steel glass clamp post kits shall be:
    1. C.R. Laurence Co., Inc., Phone: 800-421-6144
    2. Web Site: [www.crl-arch.com](http://www.crl-arch.com)
    3. Email: [sales@cr-laurence.com](mailto:sales@cr-laurence.com)
- SECTION 08 000  
GLAZING**
- 1.01 SECTION INCLUDES**
1. Glazing units.
- 1.02 ADMINISTRATIVE REQUIREMENTS**
- A. Pre-installation Meetings:** Convene a pre-installation meeting one week before starting work at this section; require attendance by each of the affected installers.
- 1.03 MATERIALS**
1. End Post.
  2. 90 Degree Corner.
  3. Standard bottom flange with cover cap.
  4. Top flange and attachment where shown in plan.
- 1.04 PREPARATION**
- A. Do not proceed with installation until:**
1. Substrate has been properly prepared and tolerances are corrected. Prepare manufacturer's methods recommended by the manufacturer for achieving the best result for the substrate under given conditions.
- 1.05 INSTALLATION**
1. Install glass clamp post kits, joints, level, and true and in accordance with manufacturer's installation instructions and recommendations.
  2. Provide anchorage details and fittings to secure to in-place construction to adjacent building structure. Separate dissimilar materials with dielectric separation.
  3. Field touch-up of finishes only acceptable if done as per manufacturer's recommendations.
  4. Return components with damaged finishes to shop for required alterations according to manufacturer's return policy, followed by complete reworking of entire unit.
  5. Secure all fasteners and components in a positive manner using manufacturer's recommended reinforcement and anchorage methods for substrate conditions. Locate brackets and hardware at spacing required per approved shop drawings.
- 1.06 CLEANING**
1. Clean glazing surfaces after installation.
  2. Verify that all surfaces are clean, free of contaminants, and free of damage.
  3. Remove protective films from metal surfaces.
  4. Clean metal surfaces with clean water and a mild detergent. Do not use abrasive chemicals, degreaser, or other ingredients that may mar or damage the finish.
- 1.07 PROTECTION**
1. Institute protective measure required throughout the remainder of the construction period to ensure that all the materials do not incur any damage or deterioration.
  2. Repair components damaged by subsequent construction activities in accordance with manufacturer's recommendations; replace damaged components that cannot be repaired to Architect's acceptance.
- END OF SECTION**

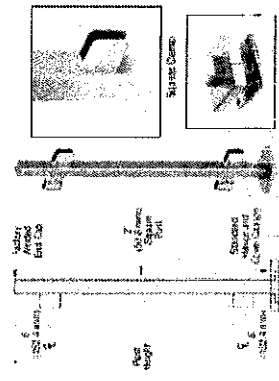

- SECTION 08 000  
GLAZING**
- 1.01 SECTION INCLUDES**
1. Glazing units.
- 1.02 ADMINISTRATIVE REQUIREMENTS**
- A. Pre-installation Meetings:** Convene a pre-installation meeting one week before starting work at this section; require attendance by each of the affected installers.
- 1.03 MATERIALS**
1. End Post.
  2. 90 Degree Corner.
  3. Standard bottom flange with cover cap.
  4. Top flange and attachment where shown in plan.
- 1.04 PREPARATION**
- A. Do not proceed with installation until:**
1. Substrate has been properly prepared and tolerances are corrected. Prepare manufacturer's methods recommended by the manufacturer for achieving the best result for the substrate under given conditions.
- 1.05 INSTALLATION**
1. Install glass clamp post kits, joints, level, and true and in accordance with manufacturer's installation instructions and recommendations.
  2. Provide anchorage details and fittings to secure to in-place construction to adjacent building structure. Separate dissimilar materials with dielectric separation.
  3. Field touch-up of finishes only acceptable if done as per manufacturer's recommendations.
  4. Return components with damaged finishes to shop for required alterations according to manufacturer's return policy, followed by complete reworking of entire unit.
  5. Secure all fasteners and components in a positive manner using manufacturer's recommended reinforcement and anchorage methods for substrate conditions. Locate brackets and hardware at spacing required per approved shop drawings.
- 1.06 CLEANING**
1. Clean glazing surfaces after installation.
  2. Verify that all surfaces are clean, free of contaminants, and free of damage.
  3. Remove protective films from metal surfaces.
  4. Clean metal surfaces with clean water and a mild detergent. Do not use abrasive chemicals, degreaser, or other ingredients that may mar or damage the finish.
- 1.07 PROTECTION**
1. Institute protective measure required throughout the remainder of the construction period to ensure that all the materials do not incur any damage or deterioration.
  2. Repair components damaged by subsequent construction activities in accordance with manufacturer's recommendations; replace damaged components that cannot be repaired to Architect's acceptance.
- END OF SECTION**

**END OF SECTION**

**BACON COMMERCIAL DESIGN LLC**  
architecture



October 28, 2016

DAVID COURTWAY, DIRECTOR  
Department of Administrative Services  
County of Jefferson; Administration Center  
729 Maple Street  
Hillsboro, Missouri 63050

Mr. Courtway:

With regard to two upcoming projects, I submit the following budget estimates for the contemplated work:

1. To remodel the customer service counter area for the **Jefferson County Recorder's Offices**, we estimate a total cost for labor, materials and supervision of .....**\$15,550.00**
2. To remodel the customer service counter area for the **Jefferson County Assessor's Offices**, we estimate a total cost for labor, materials and supervision of .....**\$19,770.00**

At your request, we can supply additional supporting information for the estimate totals for each project.

Submitted by,

# Missouri

## Division of Labor Standards

WAGE AND HOUR SECTION

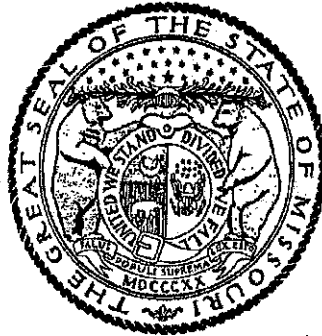

JEREMIAH W. (JAY) NIXON, Governor

### Annual Wage Order No. 23

Section 050

**JEFFERSON COUNTY**

In accordance with Section 290.262 RSMo 2000, within thirty (30) days after a certified copy of this Annual Wage Order has been filed with the Secretary of State as indicated below, any person who may be affected by this Annual Wage Order may object by filing an objection in triplicate with the Labor and Industrial Relations Commission, P.O. Box 599, Jefferson City, MO 65102-0599. Such objections must set forth in writing the specific grounds of objection. Each objection shall certify that a copy has been furnished to the Division of Labor Standards, P.O. Box 449, Jefferson City, MO 65102-0449 pursuant to 8 CSR 20-5.010(1). A certified copy of the Annual Wage Order has been filed with the Secretary of State of Missouri.

Original Signed by

John E. Lindsey, Director  
Division of Labor Standards

This Is A True And Accurate Copy Which Was Filed With The Secretary of State: March 10, 2016

Last Date Objections May Be Filed: April 11, 2016

**Prepared by Missouri Department of Labor and Industrial Relations**

OCCUPATIONAL TITLE	** Date of Increase	*	Basic Hourly Rates	Over-Time Schedule	Holiday Schedule	Total Fringe Benefits
Asbestos Worker (H & F) Insulator			\$38.36	55	60	\$21.41
Boilermaker			\$32.76	126	7	\$30.10
Bricklayer and Stone Mason	6/16		\$32.50	72	5	\$21.80
Carpenter	6/16	e	\$36.98	77	41	\$16.30
Cement Mason	6/16		\$31.16	80	6	\$17.95
Communication Technician			\$31.35	44	47	\$9.53 + 31.75%
Electrician (Inside Wireman)	10/16		\$35.70	82	71	\$10.84 + 38.5%
Electrician (Outside-Line Construction/Lineman)	9/16		\$43.75	43	45	\$5.25 + 36%
Lineman Operator	9/16		\$37.73	43	45	\$5.25 + 36%
Groundman	9/16		\$29.11	43	45	\$5.25 + 36%
Elevator Constructor		a	\$46.04	28	54	\$31.645
Glazier			\$33.40	87	31	\$23.55
Ironworker			\$32.88	11	8	\$23.825
Laborer (Building):						
General		b	\$26.71	73	7	\$12.77
First Semi-Skilled		d	\$26.71	73	7	\$12.77
Second Semi-Skilled		c	\$26.71	73	7	\$12.77
Lather			USE CARPENTER RATE			
Linoleum Layer and Cutter	6/16		\$31.83	92	26	\$16.00
Marble Mason	6/16		\$31.83	76	51	\$14.62
Marble Finisher	6/16		\$26.42	76	51	\$13.95
Millwright			\$36.34	77	41	\$15.75
Operating Engineer						
Group I	6/16		\$32.41	3	66	\$25.13
Group II	6/16		\$32.41	3	66	\$25.13
Group III	6/16		\$30.51	3	66	\$25.13
Group III-A	6/16		\$32.41	3	66	\$25.13
Group IV	6/16		\$27.05	3	66	\$25.13
Group V	6/16		\$27.05	3	66	\$25.13
Painter			\$31.65	104	12	\$13.76
Pile Driver			USE CARPENTER RATE			
Pipe Fitter			\$38.00	91	69	\$26.93
Plasterer	7/16		\$31.56	67	3	\$17.98
Plumber	7/16		\$38.00	91	69	\$26.93
Roofer \ Waterproofer			\$31.35	15	73	\$17.12
Sheet Metal Worker			\$39.63	32	25	\$21.72
Sprinkler Fitter - Fire Protection			\$41.56	66	18	\$22.02
Terrazzo Worker	6/16		\$32.30	116	5	\$13.79
Terrazzo Finisher			\$30.35	116	5	\$11.84
Tile Setter	6/16		\$31.83	76	51	\$14.62
Tile Finisher	6/16		\$26.42	76	51	\$13.95
Traffic Control Service Driver			\$28.775	22	55	\$9.045
Truck Driver-Teamster			\$30.41	35	36	\$10.82

Fringe Benefit Percentage is of the Basic Hourly Rate

\*\*Annual Incremental Increase

## Section 050

Bidder's Initials EB

**JEFFERSON COUNTY  
BUILDING CONSTRUCTION - OVERTIME SCHEDULE**

**FED:** Minimum requirement per Fair Labor Standards Act means time and one-half ( $1\frac{1}{2}$ ) shall be paid for all work in excess of forty (40) hours per work week.

**NO. 3:** Means the regular workday shall consist of eight (8) consecutive hours, exclusive of a thirty (30) minute lunch period, with pay at the straight time rate. The regular workday shall begin between the hours of 6:00 a.m. and 9:00 a.m. The Employer may have the option to schedule the work week from Monday through Thursday at ten (10) hours per day at the straight time rate of pay with all hours in excess of ten (10) hours in any one day to be paid at the applicable overtime rate. If the Employer elects to work from Monday through Thursday and is stopped due to inclement weather, holiday or other conditions beyond the control of the Employer, they shall have the option to work Friday at the straight time rate of pay to complete the forty (40) hours for the workweek. All overtime work performed on Monday through Saturday shall be paid at time and one-half ( $1\frac{1}{2}$ ) the hourly rate plus an amount equal to one-half ( $\frac{1}{2}$ ) of the hourly Total Indicated Fringe Benefits. All work performed on Sundays and recognized holidays shall be paid at double (2) the hourly rate plus an amount equal to the hourly Total Indicated Fringe Benefits. Shifts may be established when considered necessary by the Employer. Shift hours and rates will be as follows. If shifts are established, work on the First Shift will begin between 6:00 a.m. and 9:00 a.m. and consist of eight (8) hours of work plus one-half hour unpaid lunch. Hours worked during the first shift will be paid at the straight time rate of pay. The second shift shall start eight hours after the start of the first shift and consist of eight (8) hours of work plus one-half hour unpaid lunch. Work on the second shift will begin between 2:00 p.m. and 5:00 p.m. and be paid the straight time rate plus \$2.50 per hour. The third shift shall start eight hours after the start of the second shift and consist of eight (8) hours plus one-half hour unpaid lunch. Work on the third shift will begin between 10:00 p.m. and 1:00 a.m. and be paid the straight time rate plus \$3.50 per hour. The additional amounts that are to be paid are only applicable when working shifts. Shifts that begin on Saturday morning through those shifts which end on Sunday morning will be paid at time and one-half these rates. Shifts that begin on Sunday morning through those shifts which end on Monday morning will be paid at double time these rates.

**NO. 11:** Means eight (8) hours shall constitute a day's work, with the starting time to be established between 6:00 a.m. and 8:00 a.m. from Monday to Friday. Time and one-half ( $1\frac{1}{2}$ ) shall be paid for first two (2) hours of overtime Monday through Friday and the first eight (8) hours on Saturday. All other overtime hours Monday through Saturday shall be paid at double (2) time rate. Double (2) time shall be paid for all time on Sunday and recognized holidays or the days observed in lieu of these holidays.

**NO. 15:** Means the regular working day shall be scheduled to consist of at least eight (8) hours, but no more than ten (10) consecutive hours, exclusive of the lunch period. The regular working day may be scheduled to commence at any time between the hours of 5:00 a.m. and 10:00 a.m. All work performed in excess of forty (40) hours in one work week, or in excess of ten (10) hours in one work day shall be paid at the rate of one and one-half ( $1\frac{1}{2}$ ) times the regular hourly wage scale. Any work performed on a Saturday shall be paid for at the rate of one and one-half ( $1\frac{1}{2}$ ) times the regular hourly wage scale unless such Saturday work falls under the category of Saturday Make-Up Day. Any work performed by Employees anywhere on Sunday or recognized holidays, shall be paid for at the rate of double (2) time the regular wage scale. If, during the course of a work week, an Employee is unable to work for any reason, and, as a result, that Employee has not accumulated forty (40) hours of compensable time at the straight time rate, the Employer, at his option may offer the Employee the opportunity to work on Saturday at straight time; provided, however, if during the period worked by said Employee on Saturday, the Employee's compensable time at the straight time rate exceeds forty (40) hours, all time worked in excess of the forty (40) hours will be paid at the rate of one and one-half ( $1\frac{1}{2}$ ) times the regular hourly wage scale.

**NO. 22:** Means a regular work week of forty (40) hours will start on Monday and end on Friday. The regular work day shall be either eight (8) or ten (10) hours. If a crew is prevented from working forty (40) hours Monday through Friday, or any part thereof by reason of inclement weather, Saturday or any part thereof may be worked as a make-up day at the straight time rate. Employees who are part of a regular crew on a make-up day, notwithstanding the fact that they may not have been employed the entire week, shall work Saturday at the straight time rate. A workday is to begin between 6:00 a.m. and 9:00 a.m. However, the project starting time may be advanced or delayed if mutually agreed to by the interest parties. For all time worked on recognized holidays, or days observed as such, double (2) time shall be paid.



**JEFFERSON COUNTY  
BUILDING CONSTRUCTION - OVERTIME SCHEDULE**

**NO. 26:** Means that the regular working day shall consist of eight (8) hours worked between 6:00 a.m., and 5:00 p.m., five (5) days per week, Monday to Friday, inclusive. Hours of work at each jobsite shall be those established by the general contractor and worked by the majority of trades. (The above working hours may be changed by mutual agreement). Work performed on Construction Work on Saturdays, Sundays and before and after the regular working day on Monday to Friday, inclusive, shall be classified as overtime, and paid for at double (2) the rate of single time. The employer may establish hours worked on a jobsite for a four (4) ten (10) hour day work week at straight time pay for construction work; the regular working day shall consist of ten (10) hours worked consecutively, between 6:00 a.m. and 6:00 p.m., four (4) days per week, Monday to Thursday, inclusive. Any work performed on Friday, Saturday, Sunday and holidays, and before and after the regular working day on Monday to Thursday where a four (4) ten (10) hour day workweek has been established, will be paid at two times (2) the single time rate of pay. The rate of pay for all work performed on holidays shall be at two times (2) the single time rate of pay.

**NO. 32:** The regular working day shall consist of eight (8) hours of labor on the job between six (6) a.m. and four (4) p.m. and the regular working week shall consist of five (5) consecutive eight (8) hour day's of labor on the job beginning with Monday and ending with Friday of each week. The normal work week is 40 hours. All full-time or part-time labor performed during such hours shall be recognized as regular working hours and paid for at the regular hourly rate. All work performed during regular work hours on Saturdays will be paid at time and one-half (1 ½). All work performed outside of regular working hours and performed during the regular work week, shall be at double (2) times the regular rate, except that the first two (2) hours following the regular work day shall be paid at one and one-half (1½) times the regular rate. An early starting time of 6:00 a.m. may be used mutually agreed upon by the interested parties. **SHIFT RATE:** Shift work would start after 4:00 p.m. to 6:00 a.m. The first 8 hours would be at 115% of the basic wage rate. Overtime Monday through Friday would be at 1 ½ of base shift rate. Saturday regular work day hours – 1½ of base shift rate. Saturday – work after 8 hours – 2 times the basic wage rate. Sunday and Holidays – 2 times the basic wage rate. All work performed on recognized holidays and Sundays shall be paid double (2) time. Appropriate overtime rates to be based on fifteen minute increments.

**NO. 35:** Means a regular work week of forty (40) hours, will start on Monday and end on Friday. The regular work day shall be either eight (8) or ten (10) hours. If a crew is prevented from working forty (40) hours Monday through Friday, or any part thereof by reason of inclement weather, Saturday or any part thereof maybe worked as a make-up day at the straight time rate. Employees who are part of a regular crew on a make-up day, notwithstanding the fact that they may not have been employed the entire week, shall work Saturday at the straight time rate. A work day is to begin between 6:00 a.m. and 9:00 a.m. However, the project starting time maybe advanced or delayed if mutually agreed to by the interested parties. For all time worked on recognized holidays, or days observed as such, double (2) time shall be paid.

**NO. 43:** Eight (8) hours shall constitute a work day between the hours of 7:00 a.m. and 4:30 p.m. Forty (40) hours within five (5) days, Monday through Friday inclusive, shall constitute the work week. Work performed in the 9th and 10th hour, Monday through Friday, shall be paid at time and one-half (1½) the regular straight time rate of pay. Contractor has the option to pay two (2) hours per day at the time and one-half (1½) the regular straight time rate of pay between the hours of 6:00 a.m. and 5:30 p.m., Monday through Friday. Work performed outside the regularly scheduled working hours and on Saturdays, Sundays and recognized legal holidays, or days celebrated as such, shall be paid for at the rate of double (2) time.

**NO. 44:** Means forty (40) hours shall constitute a work week, Monday through Friday. Eight (8) hours shall constitute a work day. Hours of work shall be between the hours of 7:00 a.m. and 4:30 p.m. All work performed before 7:00 a.m. and after 4:30 p.m. and all work performed in excess of eight (8) hours in any one work day, over forty (40) hours in any work week and the first eight (8) hours of work on Saturday, shall be paid at the rate of one and one-half (1½) times the regular rate of pay. All hours worked in excess of eight (8) hours on Saturday, all hours worked on Sunday and on holidays, or days that may be celebrated as such, and as designated by the federal government, shall be paid at two (2) times the regular rate of pay. All shifts for work performed between the hours of 4:30 p.m. and 1:00 a.m. shall receive eight (8) hours pay at the regular hourly rate of pay plus two dollars (\$2.00) per clock hour. All work performed between the hours of 12:30 a.m. and 9:00 a.m. on a third shift shall receive eight (8) hours pay at the regular hourly rate plus four dollars (\$4.00) per clock hour. All overtime work required after the completion of a regular shift shall be paid at one and one-half times (1½ x) the "shift" hourly rate.

**JEFFERSON COUNTY  
BUILDING CONSTRUCTION - OVERTIME SCHEDULE**

**NO. 55:** Means the regular work day shall be eight (8) hours between 6:00 a.m. and 4:30 p.m. The first two (2) hours of work performed in excess of the eight (8) hour work day, Monday through Friday, and the first ten (10) hours of work on Saturday, shall be paid at one & one-half (1½) times the straight time rate. All work performed on Sunday, observed holidays and in excess of ten (10) hours a day, Monday through Saturday, shall be paid at double (2) the straight time rate.

**NO. 66:** Means eight (8) hours shall constitute a day's work beginning at 7:00 a.m. (or 8:00) A.M. and ending at 3:30 (or 4:30) P.M. The work week shall be forty (40) hours beginning Monday at 7:00 a.m. (or 8:00) A.M. and ending Friday at 3:30 (or 4:30) P.M. The Employer at his option may use a flexible starting time between the hours of 6:00 a.m. and 8:00 a.m. All overtime, that is worked outside of the above established working hours of Monday through Friday, shall be paid at double (2) time, including Saturdays, Sundays and Holidays.

**NO. 67:** Means eight (8) hours shall constitute a day's work, with a flexible starting time to begin between 6:00 a.m. to 8:00 a.m., five (5) days a week, Monday through Friday. Any work over eight (8) hours in any one day shall be at the overtime rate, which is time & one-half (1½). Any work on Saturday shall be at time & one-half (1½), unless a Make-Up Day due to inclement weather is in effect. Any work on Sundays or holidays shall be at double (2) time. Four (4) days, ten (10) hours each day to be worked during Monday through Friday, shall be paid at straight time. A Make-Up Day Due To Inclement Weather Only - Employee(s) will be permitted to work an eight (8) hour make-up day on Saturday only, and the employee will receive the regular straight time wage rate.

**NO. 72:** Means that except as is otherwise provided herein, the work week shall be determined to begin at 8:00 a.m. Wednesday and end at 4:30 p.m. on the following Tuesday. Except as herein provided, working hours are from 8:00 a.m. to 11:55 a.m. and 12:30 p.m. to 4:25 p.m. and no more than the regular hours shall be worked during the forenoon or afternoon at the regular rate. In the case of days of inclement weather starting time and quitting time may be adjusted so long as the hours worked on such days do not exceed eight (8) and do not extend beyond 4:30 p.m. In circumstances where the Employee or Employees have regularly been working overtime on a particular day or days, no adjustment in the starting time shall operate to deprive Employees of overtime pay, which they would have otherwise received but for the change in the starting time. The parties understand that the application of the provisions of the preceding sentence will result in Employees receiving overtime pay even where they have not worked more than with (8) hours on a particular day. Regardless of the starting time, the forenoon working hours shall end at 11:55 a.m. and the afternoon working hours shall begin at 12:30 p.m. and end 8 hours and 25 minutes after the starting time fixed by the Employer for forenoon hours. Work performed by an employee on a non-holiday Saturday, except as hereinafter provided, or at night or before or after regular working hours on a non-holiday weekday, shall be considered overtime work, for which Employees working during such time shall be paid at the rate of one and one-half (1½) times their regular hourly wage rate for each hour or fraction thereof, worked during such time. Work performed on a Sunday or the recognized holidays shall be considered overtime work for which the Employee shall be paid twice the amount of his or her regular hourly wage rate for each hour or fraction thereof worked on any such day.

**JEFFERSON COUNTY  
BUILDING CONSTRUCTION - OVERTIME SCHEDULE**

**NO. 73:** Means eight (8) hours shall constitute a day's work to begin at 8:00 a.m. and end at 4:30 p.m. The starting time may be advanced one (1) or two (2) hours. Employees shall receive time and one-half (1½) for all time they are required to work before 8:00 a.m., during the lunch period or after 4:30 p.m. unless the starting time is advanced as provided above. Forty (40) hours shall constitute a week's work, Monday through Friday, or any part thereof by reason of inclement weather (rain or mud), Saturday or any part thereof may be worked as a make-up day at the straight time rate. The Employer shall have the option of working five (5) eight (8) hour day's or four (4) ten (10) hour day's Monday through Friday. If an Employer elects to work five (5) eight (8) hour days during any work week, hours worked more than eight (8) per day or forty (40) per week shall be paid at time and one-half (1½) the hourly rate Monday through Friday. If an employer elects to work four (4) ten (10) hour days in any week, work performed more than ten (10) hours per day or forty (40) hours per week shall be paid at time and one-half (1½) the hourly rate Monday through Friday. If an Employer is working ten (10) hour days and loses a day due to inclement weather, he may work ten (10) hours Friday at straight time. All time over the regular workday as defined and all hours worked on Saturday shall be paid at the rate of one and one-half (1½) the regular rate of wages. If workmen are required to work recognized holidays or days observed as such, or on Sunday, they shall receive double (2) the regular rate of pay for such work. If a laborer is assisting another craft on a make-up day and the other craft is receiving overtime pay the laborer shall receive the same overtime multiple as the craft assisted. No overtime rates shall be broken down into less than thirty (30) minute units of time. Projects that cannot be performed during regular workday: Building construction work, if required by the owner, the contractor may perform work outside the normal hours and employees shall be paid applicable straight time hourly wage rate plus a premium of \$1.50 per hour for the first eight hours worked. Any hours worked in excess of eight hours shall be paid at the applicable overtime rate plus \$1.50 per hour premium. Shift work: The Employer may elect to work, one, two or three shifts on any work. When two or more shifts are worked on any operation, the first shift or day shift shall consist of eight (8) hours exclusive of lunch time; the second or swing shift consist of eight (8) hours' work for eight and one-half hours pay, exclusive of lunch time; the third or graveyard shift shall consist of eight (8) hours' work for nine (9) hours' pay exclusive of lunch time. The swing shift shall be paid twenty-five cents (\$.25) per hour above the regular rate of pay. The graveyard shift shall be paid fifty cents (\$.50) per hour above the regular rate of pay. Multiple shift (second or third shift) operation will not be construed on the entire project if at any time it is deemed advisable and necessary for the employer to a specific operation. However, no shift shall be started between midnight and 6:00 a.m. except the graveyard shift on a three (3) shift operation, or except in unusual or emergency, regardless if the project is working one (1) or two (2) shift. Shifts shall be established for a minimum of three (3) consecutive workdays. When 2-10 or 12 hour shifts are worked, the second shift shall receive \$.50 per hour above regular rate of pay. When the employer elects to work 2-10 or 12 hour shifts, the first 8 hours shall be at straight time rates. The remaining 2 or 4 hours shall be at the overtime rate of time and one-half.

**NO. 76:** Means the standard workday shall consist of eight (8) hours of work between the hours of 8:00 a.m. and 4:30 p.m. with a thirty (30) minute unpaid lunch hour occurring in the middle of the shift. The standard workweek shall consist of five standard workdays commencing on Monday and ending on Friday. The normal starting and quitting times may be changed by mutual consent of interested parties. All time worked before and after the established eight (8) hour workday, Monday through Friday, and all time worked on Saturday, shall be paid for at the rate of time & one-half (1½) the hourly base wage rate in effect. All time worked on Sunday and holidays shall be paid at the rate of double (2) the hourly wage in effect. All work done on Saturday will be done at time & one-half (1½), unless Saturday shall be used as a make-up day. If an employee should lose one or more days in a work week and use Saturday as a make-up day the pay shall be at the regular hourly base wage rate and benefits.

**NO. 77:** Means the regular workday shall consist of eight (8) consecutive hours, exclusive of a thirty (30) minute lunch period, with pay at the regular straight time hourly rate. The regular workday shall begin on the job site between the hours of 6:00 a.m. and 8:00 a.m. with the starting time to be determined by the Employer, unless project owner requires different starting time. This adjustable starting time can, at the Employer's option, be staggered to permit starting portions of the work force at various times within the prescribed hours. The Employer may establish a four (4) ten (10) hour shift exclusive of the thirty (30) minute lunch period at the straight time wage rate. Forty (40) hours per week shall constitute a week's work Monday through Thursday. In the event a job is down due to weather conditions, safety or other conditions beyond the control of the Employer, then Friday may, at the option of the employer, be worked as a make-up day at the straight time wage rate. Straight time is not to exceed ten (10) hours a day or forty (40) hours per week. Time and one-half (1½) shall be paid for all overtime hours worked during the week, Monday through Friday and for all work performed on Saturday. Double (2) time shall be paid for all time worked on Sunday and recognized holidays.

**JEFFERSON COUNTY  
BUILDING CONSTRUCTION - OVERTIME SCHEDULE**

**NO. 80:** Means eight (8) hours shall constitute the regular work day and forty (40) hours a work week, Monday through Friday. The Employer shall establish the starting time between 6:30 a.m. through 9:00 a.m. An Employer may further adjust the starting time up to 9:30 a.m. throughout the year. Time and one-half (1½) shall be paid after eight (8) consecutive hours worked after the established starting time and for hours worked before the established starting time. Time and one-half (1½) shall be paid for work performed on Saturdays. Work performed on Sundays and Holidays shall be paid at the double (2) time rate of pay. The Employer when working on Highway and Road Work may have the option to schedule the work week for his paving crew only from Monday through Thursday at ten (10) hours per day at the straight time rate of pay with all hours in excess of ten (10) hours in any one day to be at the applicable overtime rate of time and one-half (1½). If the Employer elects to work from Monday through Thursday and is stopped due to inclement weather (rain, snow, sleet falling), the Employer shall have the option to work Friday at the straight time rate of pay to complete the forty (40) hours.

**NO. 82:** Means the work day shall consist of eight (8) hours worked between 7:00 a.m. and 4:30 p.m. Forty (40) hours will constitute the work week from Monday through Friday, inclusive. Up to four (4) hours of overtime work per day performed before or after the assigned normal work day, (twelve (12) continuous hours, starting no earlier than 6:00 a.m., Monday through Friday), shall be paid at a rate of one and one-half times (1.5x) that employee's hourly rate. Any additional overtime, Monday through Friday, shall be paid at two times (2x) the regular rate of pay. The first eight hours of overtime work on Saturday shall be paid at the rate of one and one-half times (1.5x) the regular rate of pay. Hours worked in excess of eight (8) hours on Saturday shall be paid at two times (2x) the regular rate of pay. Double time shall be paid for work performed on Sundays, recognized legal holidays or days that may be celebrated as such as designated by the federal government. All shifts for work performed between the hours of 4:30 p.m. and 1:00 a.m. shall be paid at the regular hourly rate plus two dollars (\$2.00) per clock hour. All shifts for work performed between the hours of 12:30 a.m. and 9:00 a.m. shall be paid at the regular hour rate plus four dollars (\$4.00) per clock hour. All overtime work required after the completion of a regular shift shall be paid at one and one-half times (1.5x) the "shift" hourly rate.

**NO. 87:** Means eight (8) hours starting between 6:00 a.m. and 8:00 a.m. and ending between 2:30 p.m. and 4:30 p.m. at the Employers discretion shall constitute a day's work. Any work prior to 6:00 a.m. or after eight (8) hours shall be paid at the overtime rate. Five (5) days from Monday through Friday inclusive shall constitute a regular work week. All hours before and after these regular hours shall be considered overtime and shall be paid for at the rate of double (2) time. All work on Saturday and Sunday shall be paid at double (2) the prevailing scale of wages.

**NO. 91:** Means eight (8) hours shall constitute a day's work commencing at 7:00 a.m. and ending at 3:30 p.m., allowing one-half (½) hour for lunch. The option exists for the Employer to use a flexible starting time between the hours of 6:00 a.m. and 9:00 a.m. The regular workweek shall consist of forty (40) hours of five (5) workdays, Monday through Friday. The workweek may consist of four (4) ten (10) hour days from Monday through Thursday, with Friday as a make-up day. If the make-up day is a holiday, the employee shall be paid at the double (2) time rate. The employees shall be paid time and one-half (1½) for work performed on Saturdays, before the regular starting time or after the regular quitting time or over eight (8) hours per work day (unless working a 10-hour work day, then time and one-half (1½) is paid for work performed over ten (10) hours a day) or over forty (40) hours per work week. Work performed on Sundays and recognized holidays shall be paid at the double (2) time rate of pay. **SHIFT WORK:** When it is necessary for the project to operate in shifts, there will be three (3) eight (8) hour shifts commencing at 8:00 a.m. Shift work must continue for a period of not less than three (3) consecutive work days, two (2) days which must be regular work days (Monday through Friday). In the event the second or third shift of any regular work day shall fall into a Saturday or a holiday, such extension into a Saturday or holiday shall be considered as part of the previous workday and employees shall be paid at the regular shift rate. The first day shift shall work a regular eight (8) hour day at regular rates. The second shift shall be eight (8) hours regular time pay plus \$2.50 per hour premium for eight (8) hours work. Third shift will be for eight (8) hours regular time pay plus \$3.00 per hour premium for eight (8) hours work.

**NO. 92:** Means all work performed from 8:00 a.m. to 4:30 p.m., Monday through Friday, will be at straight time pay up to forty (40) hours per week. All work performed Monday through Friday before 8:00 a.m. and after 4:30 p.m. will be done at time and one-half (1½). All work done on Saturday will be done at time and one-half (1½), unless the employer and employee agree that Saturday shall be used as a make-up day. The Employer may use a flexible starting time of 7:00 a.m. to 8:00 a.m., and quitting time of 3:30 p.m. to 4:30 p.m., and any such different work starting time shall determine whether wages are payable at the straight rate or the premium rate. All work performed on Saturday shall be paid for at time and one-half (1½), unless the Saturday has been used as a make-up day. All work performed on Sunday and holidays shall be paid for at the rate of double (2) time.

**JEFFERSON COUNTY  
BUILDING CONSTRUCTION - OVERTIME SCHEDULE**

**NO. 104:** Means eight (8) hours per day shall constitute a standard work day between the hours of 6:00 a.m. and 8:00 p.m. The standard work week shall be forty (40) hours between 6:00 a.m. on Monday and ending 8:00 p.m. on Friday. An overtime rate of time and one-half (1½) the base hourly rate shall be paid on all hours in excess of eight (8) hours in a day Monday through Friday. Saturdays shall be considered overtime and work done on Saturday shall be paid at time and one-half (1½) the prevailing scale. Sundays and holidays shall be considered overtime and work done on these days shall be paid at double (2) the prevailing scale.

**NO. 116:** Means the standard work day shall consist of eight (8) hours of work between the hours of 8:00 a.m. and 4:30 p.m. The standard work week shall consist of five standard work days commencing on Monday and ending on Friday inclusive. All time worked before and after the established eight (8) hour work day, Monday through Friday, and all time worked on Saturdays, shall be paid for at the rate of time & one-half (1½) the hourly base wage rate in effect. All time worked on Sundays and recognized holidays shall be paid for at the rate of double (2) the hourly base wage rate in effect.

**NO. 126:** Means eight (8) hours per day shall constitute a day's work and forty (40) hours per week, Monday through Friday, shall constitute a week's work. The regular starting time shall be 8:00 a.m. If a second or third shift is used, the regular starting time of the second shift shall be 4:30 p.m. and the regular starting period for the third shift shall be 12:30 a.m. These times may be adjusted by the employer. The day shift shall work a regular eight (8) hours shift as outlined above. Employees working a second shift shall receive an additional \$0.25 above the regular hourly rate and perform seven and one-half (7½) hours work for eight (8) hours pay. Third shift employees shall be paid an additional \$0.50 above the regular hourly rate and work seven (7) hours for eight (8) hours pay. When circumstances warrant, the Employer may change the regular workweek to four (4) ten-hour days at the regular time rate of pay. All time worked before and after the established workday of eight (8) hours, Monday through Friday, and all time worked on Saturday shall be paid at the rate of time and one-half (1½) except in cases where work is part of an employee's regular Friday shift. All time worked on Sunday and recognized holidays shall be paid at the double (2) time rate of pay except in cases where work is part of an employee's previous day's shift. For all overtime hours worked \$27.96 of the fringe benefits portion of the prevailing wage shall be paid at the same overtime rate at which the cash portion of the prevailing wage is to be paid. The remaining \$1.24 of the fringe benefit portion of the prevailing wage may be paid at straight time.

## JEFFERSON COUNTY HOLIDAY SCHEDULE – BUILDING CONSTRUCTION

**NO. 3:** All work done on New Year's Day, Decoration Day, July 4th, Labor Day, Veteran's Day, Thanksgiving and Christmas shall be compensated at the double (2) time rate of pay. When any of these holidays fall on a Sunday, the following Monday shall be observed.

**NO. 5:** All work that shall be done on New Year's Day, Memorial Day, Independence Day, Labor Day, Veteran's Day, Thanksgiving Day, and Christmas Day shall be paid twice the amount of his or her regular hourly wage rate for each hour of fraction thereof worked on any such day.

**NO. 6:** The following days are recognized as holidays: New Year's Day, Memorial Day, Fourth of July, Labor Day, Veterans Day, Thanksgiving Day, Christmas Day and any additional holidays which may be mutually agreed upon. Whenever any such holiday falls on a Sunday, the following Monday shall be recognized and observed as the holiday. Work performed on Sundays and holidays shall be paid at the double time rate of pay. No work shall be performed on Labor Day.

**NO. 7:** The following days are assigned days and are recognized as holidays: New Year's Day, Memorial Day, Independence Day, Labor Day, Veteran's Day, Thanksgiving Day, and Christmas Day. If a holiday falls on a Sunday, it shall be observed on the following Monday. If a holiday falls on a Saturday, it shall be observed on the preceding Friday. No work shall be performed on Labor Day except in case of jeopardy to work under construction. This is applied to protect Labor Day. When a holiday falls during the normal workweek, Monday through Friday, it shall be counted as eight (8) hours toward the forty (40) hour week. However, no reimbursement for these eight (8) hours is to be paid to the workman unless worked. If workman are required to work the above enumerated holidays or days observed as such, or on Sunday, they shall receive double (2) the regular rate of pay for such work.

**NO. 8:** All work performed on New Year's Day, Memorial Day, Independence Day, Labor Day, Veteran's Day, Thanksgiving Day, and Christmas Day, or the days observed in lieu of these holidays, shall be paid at the double time rate of pay.

**NO. 12:** All work done on New Year's Day, Decoration Day, Independence Day, Veteran's Day, Thanksgiving Day and Christmas Day shall be paid at the double time rate of pay. Should any of these days fall on Sunday, then the following day shall be observed as the holiday. Under no circumstances shall employees be permitted to work on Labor Day.

**NO. 18:** All work done on New Year's Day, Memorial Day, July 4th, Labor Day, Veteran's Day, Thanksgiving Day, the Friday following Thanksgiving and Christmas Day shall be paid at the double time rate of pay. When one of the above holidays falls on Sunday, the following Monday shall be considered the holiday, and when one of the above holidays falls on Saturday, the preceding Friday shall be considered the holiday, and all work performed on said day(s) shall be paid at the double time rate.

**NO. 25:** All work done on New Year's Day, Martin Luther King Day, Memorial Day, Independence Day, Labor Day, Veteran's Day, Thanksgiving Day, the day after Thanksgiving, Christmas Day, Presidential Election Day, or days locally observed as such, and Saturday and Sunday shall be recognized as holidays and shall be paid at the double (2) time rate of pay. If a named holiday falls on a Saturday, the holiday will be observed on the preceding Friday. When a named holiday falls on Sunday, the Monday after will be observed as the holiday. Appropriate overtime rates to be based on fifteen minute increments.

**NO. 26:** All work done on New Year's Day, Memorial Day, Fourth of July, Labor Day, Veteran's Day, Thanksgiving Day and Christmas Day shall be paid at the double time rate of pay. When a Holiday occurs on Saturday it shall not be observed on either the previous Friday or the following Monday. Such days shall be regular work days. If such a holiday occurs on Sunday it shall be observed on the following Monday.

**NO. 31:** All work done on New Year's Day, Presidents Day, Good Friday, Memorial Day, Fourth of July, Labor Day, Veteran's Day, Thanksgiving Day, Friday after Thanksgiving Day, Christmas Day, and Employee's Birthday shall be paid at the double time rate of pay. If a holiday falls on Sunday, the following Monday will be observed as the recognized holiday. If a holiday falls on Saturday, the preceding Friday will be observed as the recognized holiday.

**JEFFERSON COUNTY  
HOLIDAY SCHEDULE – BUILDING CONSTRUCTION**

**NO. 36:** The following days are recognized as holidays: New Year's Day, Memorial Day, Independence Day, Labor Day, Thanksgiving Day and Christmas Day. If a holiday falls on a Sunday, it shall be observed on the following Monday. No work shall be performed on Labor Day except in case of jeopardy to work under construction. This rule is applied to protect Labor Day. When a holiday falls during the normal work week, Monday through Friday, it shall be counted as eight (8) hours toward the forty (40) hour week; however, no reimbursement for this eight (8) hours is to be paid the workman unless worked. An Employer working a four (4) day, ten (10) hour schedule may use Friday as a make-up day when an observed holiday occurs during the work week. Employees have the option to work that make-up day. If workmen are required to work the above enumerated holidays, or days observed as such, they shall receive double (2) the regular rate of pay for such work.

**NO. 41:** The following days shall be observed as legal holidays: New Year's Day, Memorial Day, Fourth of July, Labor Day, Veteran's Day, Thanksgiving Day and Christmas Day. No work shall be performed on the Fourth of July, Labor Day or Christmas Day. Any work performed on the above holidays shall be paid for at two (2) times the regular straight time rate of pay. When any of the above holidays fall on Sunday, the following Monday shall be observed as such holiday. If a holiday falls on Saturday, it shall not be considered to be observed on the previous Friday or following Monday. Such days shall be regular workdays.

**NO. 45:** All work performed on New Year's Day, Memorial Day, Independence Day, Labor Day, Veteran's Day, Thanksgiving Day, the day after Thanksgiving, the day before Christmas, and Christmas Day, shall be paid at the double time rate of pay.

**NO. 47:** The following holidays are recognized: New Year's Day, Memorial Day, Fourth of July, Labor Day, Veteran's Day, Thanksgiving Day, the day after Thanksgiving and Christmas Day. When a holiday listed above falls on Saturday, it shall be celebrated on the Friday preceding the holiday. When a holiday falls on Sunday, the following Monday shall be observed. Holidays referred to above shall be paid for at the double (2) time rate of pay when worked.

**NO. 51:** All time worked on Sundays and recognized holidays shall be paid for at the rate of double (2) the hourly base wage rate in effect. The Employer agrees to recognize the following holidays: New Year's Day, Memorial Day, Independence Day, Labor Day, Veteran's Day, Thanksgiving Day and Christmas Day. If the holiday falls on Sunday, it shall be recognized on the following Monday. If the holiday falls on a Saturday, it shall be recognized as a Saturday only holiday.

**NO. 54:** All work performed on New Year's Day, Memorial Day, Independence Day, Labor Day, Veteran's Day, Thanksgiving Day, the Friday after Thanksgiving Day, and Christmas Day shall be paid at the double (2) time rate of pay. When a holiday falls on Saturday, it shall be observed on Friday. When a holiday falls on Sunday, it shall be observed on Monday.

**NO. 55:** The following days are recognized as holidays: New Year's Day, Memorial Day, Independence Day, Labor Day, Thanksgiving Day and Christmas Day. If a holiday falls on a Sunday, it shall be observed on the following Monday. No work shall be performed on Labor Day except in case of jeopardy to work under construction. This rule is applied to protect Labor Day. When a holiday falls during the normal work week, Monday through Friday, it shall be counted as eight (8) hours toward the forty (40) hour week; however, no reimbursement for this eight (8) hours is to be paid the workmen unless worked. An Employer working a four (4) day, ten (10) hour schedule may use Friday as a make up day when an observed holiday occurs during the work week. Employees have the option to work that make up day. If workmen are required to work the above enumerated holidays, or days observed as such, they shall receive double (2) the regular rate of pay for such work.

**NO. 60:** All work performed on New Year's Day, Armistice Day (Veteran's Day), Decoration Day (Memorial Day), Independence Day (Fourth of July), Thanksgiving Day and Christmas Day shall be paid at the double time rate of pay. No work shall be performed on Labor Day except when triple (3) time is paid. When a holiday falls on Saturday, Friday will be observed as the holiday. When a holiday falls on Sunday, the following Monday shall be observed as the holiday.

**JEFFERSON COUNTY  
HOLIDAY SCHEDULE – BUILDING CONSTRUCTION**

**NO. 66:** All work performed on Sundays and the following recognized holidays, or the days observed as such, of New Year's Day, Decoration Day, Fourth of July, Labor Day, Veteran's Day, Thanksgiving Day and Christmas Day, shall be paid at double (2) the hourly rate plus an amount equal to the hourly Total Indicated Fringe Benefits. Whenever any such holidays fall on a Sunday, the following Monday shall be observed as a holiday.

**NO. 69:** All work performed on New Year's Day, Memorial Day, July Fourth, Labor Day, Veteran's Day, Thanksgiving Day or Christmas Day shall be compensated at double (2) their straight-time hourly rate of pay. Friday after Thanksgiving and the day before Christmas are also holidays, however, if the employer chooses to work the normal work hours on these days, the employee will be paid at straight -time rate of pay. If a holiday falls on a Saturday, the holiday will be observed on Saturday; if a holiday falls on a Sunday, the holiday will be observed on the following Monday.

**NO. 71:** All work performed on the following recognized holidays, or days that may be celebrated as such, shall be paid at the double (2) time rate of pay: New Year's Day, Memorial Day, Independence Day, Labor Day, Veterans Day, Thanksgiving Day, Day after Thanksgiving and Christmas Day. If a holiday falls on Sunday, it shall be celebrated on Monday. If a holiday falls on Saturday, it shall be celebrated on the Friday proceeding such Saturday.

**NO. 73:** The following days are recognized as holidays: New Year's Day, Memorial Day, Fourth of July, Labor Day, Veteran's Day (or mutually agreed date of the Friday after Thanksgiving Day may be substituted for Veteran's Day), Thanksgiving Day and Christmas Day, or in the event that any of said Holidays falls on Sunday, then the day or days generally recognized as such. Any work performed anywhere on any of the aforesaid Holidays, or on the day or days recognized and observed as such, shall be paid for at double (2) time the regular hourly rate.



Heavy Construction Rates for  
JEFFERSON County

REPLACEMENT PAGE

Section 050

OCCUPATIONAL TITLE	* Date of Increase	Basic Hourly Rates	Over-Time Schedule	Holiday Schedule	Total Fringe Benefits
Carpenter	6/16	\$36.21	23	16	\$16.10
Cement Mason	6/16	\$31.16	17	11	\$17.95
Electrician (Outside-Line Construction/Lineman)	9/16	\$43.75	9	12	\$5.25 + 36%
Lineman Operator	9/16	\$37.73	9	12	\$5.25 + 36%
Lineman - Tree Trimmer		\$25.24	32	31	\$10.20 + 3%
Groundman	9/16	\$29.11	9	12	\$5.25 + 36%
Groundman - Tree Trimmer		\$20.00	32	31	\$7.89 + 3%
Laborer					
General Laborer	6/16	\$29.76	2	4	\$13.17
Skilled Laborer	6/16	\$30.36	2	4	\$13.17
Millwright	6/16	\$36.21	23	16	\$16.10
Operating Engineer					
Group I	6/16	\$32.41	10	9	\$25.13
Group II	6/16	\$32.41	10	9	\$25.13
Group III	6/16	\$31.11	10	9	\$25.13
Group IV	6/16	\$27.65	10	9	\$25.13
Oil-er-Driver	6/16	\$28.11	10	9	\$25.13
Pile Driver	6/16	\$36.21	23	16	\$16.10
Traffic Control Service Driver		\$28.775	26	25	\$9.045
Truck Driver-Teamster		\$30.41	25	21	\$10.82

Use Heavy Construction Rates on Highway and Heavy construction in accordance with the classifications of construction work established in 8 CSR 30-3.040(3).

Use Building Construction Rates on Building construction in accordance with the classifications of construction work established in 8 CSR 30-3.040(2).

If a worker is performing work on a heavy construction project within an occupational title that is not listed on the Heavy Construction Rate Sheet, use the rate for that occupational title as shown on the Building Construction Rate sheet.

\*Annual Incremental Increase

ANNUAL WAGE ORDER NO. 23

9/16

Request for Proposal

28 of 34

Bidder's Initials EB

**REPLACEMENT PAGE  
JEFFERSON COUNTY  
OVERTIME SCHEDULE - HEAVY CONSTRUCTION**

**FED:** Minimum requirement per Fair Labor Standards Act means time and one-half (1 ½) shall be paid for all work in excess of forty (40) hours per work week.

**NO. 2:** Means a regular workweek shall be forty (40) hours and will start on Monday and end on Friday. The Employer shall have the option of working five 8-hour days or four 10-hour days Monday through Friday. If an Employer elects to work five 8-hour days during any workweek, hours worked more than eight (8) per day or 40 per week shall be paid at time and one-half the hourly rate Monday through Friday. If an Employer elects to work four 10-hour days in a week, work performed more than ten (10) hours per day or 40 hours per week shall be paid at time and one-half the hourly rate Monday through Friday. When working a five 8-hour day schedule and an Employer is prevented from working forty (40) hours Monday through Friday, or any part thereof, by reason of inclement weather, Saturday or any part thereof may be worked as a make-up day at the straight time rate. If an Employer is working a four 10-hour day schedule and loses a day due to inclement weather, he may work 10 hours Friday at straight time. All hours worked over the 40 hours Monday through Friday will be paid at 1 ½ overtime rate. A workday shift is to begin at the option of the Employer, between 6:00 a.m. and not later than 9:00 a.m. However, the project starting time may be advanced or delayed if required. If workmen are required to work the enumerated holidays or days observed as such or Sundays, they shall receive double (2) the regular rate of pay for such work. Overtime shall be computed at one-half (1/2) hour intervals. Shift: The Contractor may elect to work one, two or three shifts on any work. When operating on more than one shift, the shifts shall be known as the day shift, swing shift, and graveyard shift as such terms are recognized in the industry. When two shifts are worked on any operation, the shifts will consist of eight (8) or ten (10) hours exclusive of lunchtime. When three shifts are worked the first day or day shift will consist of eight (8) hours exclusive of lunchtime. The second or swing shift shall consist of seven and one-half (7 1/2) hours work for eight hours pay, exclusive of lunchtime, and the third or the graveyard shift shall consist of seven (7) hours work for eight (8) hours pay, exclusive of the lunchtime. All time in excess of normal shifts shall be considered overtime. Multiple shift (the two or three shift) operation will not be construed on the entire project if at anytime it is deemed advisable and necessary for the Employer to multiple shift a specific operation. However, no shift shall be started between midnight and six a.m. except the graveyard shift on a three-shift operation, or except in an unusual or emergency situation. If an Employer starts a shift between midnight and 6 a.m. except the graveyard shift on a three-shift operation, he shall reimburse all employees for the entire shift at the double time rate. Completion of the second shift on a two-shift operation or completion of the graveyard shift on a three-shift operation that carries over into Saturday morning, shall be at the straight time rate. Overtime shall be computed at ½ hour intervals.

**NO. 9:** Eight (8) hours shall constitute a work day between the hours of 7:00 a.m. and 4:30 p.m. Forty (40) hours within five (5) days, Monday through Friday inclusive, shall constitute the work week. Work performed in the 9th and 10th hour, Monday through Friday, shall be paid at time and one-half (1½) the regular straight time rate of pay. Contractor has the option to pay two (2) hours per day at the time and one-half (1½) the regular straight time rate of pay between the hours of 6:00 a.m. and 5:30 p.m., Monday through Friday. Work performed in the first eight (8) hours on Saturday shall be paid at the rate of one and eight tenths (1.8) the regular straight time rate. Work performed outside these hours and on Sundays and recognized legal holidays, or days celebrated as such, shall be paid for at the rate of double (2) time.

**REPLACEMENT PAGE  
JEFFERSON COUNTY  
OVERTIME SCHEDULE - HEAVY CONSTRUCTION**

**NO. 10:** Means the regular workday for which employees shall be compensated at straight time hourly rate of pay shall, unless otherwise provided for, begin at 8:00 a.m. and end at 4:30 p.m. The regular workweek shall consist of five (5) days, Monday through Friday, beginning at 8:00 a.m. and ending at 4:30 p.m. except as may be modified. The starting time may be either advanced or delayed one hour or two hours at the discretion of the Employer. The Employer may have the option to schedule his work week from Monday through Thursday at ten (10) hours per day at the straight time rate of pay with all hours in excess of ten (10) hours in any one day to be at the applicable overtime rate. If the Employer elects to work Monday through Thursday and is stopped due to inclement weather, holidays or other conditions beyond the control of the Employer, he shall have the option to work Friday at the straight time rate of pay to complete the forty (40) hour workweek. All necessary overtime and work performed on Saturday, shall be paid at time and one-half (1½) the hourly rate, plus an amount equal to one-half (½) of the hourly Total Indicated Fringe Benefits. All work performed on Sundays and recognized holidays shall be paid at double (2) the hourly rate, plus an amount equal to the hourly Total Indicated Fringe Benefits. Shifts may be established when considered necessary by the Employer. Shift hours and rates will be as follows. If shifts are established, work on the First Shift will begin between 6:00 a.m. and 9:00 a.m. and consist of eight (8) hours of work plus one-half hour unpaid lunch. Hours worked during the first shift will be paid at the straight time rate of pay. The second shift shall start eight hours after the start of the first shift and consist of eight (8) hours of work plus one-half hour unpaid lunch. Work on the second shift will begin between 2:00 p.m. and 5:00 p.m. and be paid the straight time rate plus \$2.50 per hour. The third shift shall start eight hours after the start of the second shift and consist of eight (8) hours plus one-half hour unpaid lunch. Work on the third shift will begin between 10:00 p.m. and 1:00 a.m. and be paid the straight time rate plus \$3.50 per hour. The additional amounts that are to be paid are only applicable when working shifts. Shifts that begin on Saturday morning through those shifts which end on Sunday morning will be paid at time and one-half these rates. Shifts that begin on Sunday morning through those shifts which end on Monday morning will be paid at double time these rates.

**NO. 17:** Means eight (8) hours shall constitute the regular work day and forty (40) hours a work week, Monday through Friday. The Employer shall establish the starting time between 6:30 a.m. through 9:00 a.m. An Employer may further adjust the starting time up to 9:30 A.M. throughout the year. Time and one-half (1½) shall be paid after eight (8) consecutive hours worked after the established starting time and for hours worked before the established starting time. Time and one-half (1½) shall be paid for work performed on Saturdays. Work performed on Sundays and Holidays shall be paid at the double (2) time rate of pay. The Employer when working on Highway and Road Work may have the option to schedule the work week for his paving crew only from Monday through Thursday at ten (10) hours per day at the straight time rate of pay with all hours in excess of ten (10) hours in any one day to be at the applicable overtime rate of time and one-half (1½). If the Employer elects to work from Monday through Thursday and is stopped due to inclement weather (rain, snow, sleet falling), the Employer shall have the option to work Friday at the straight time rate of pay to complete the forty (40) hours.

**NO. 23:** Means the regular workweek shall start on Monday and end on Friday, except where the Employer elects to work Monday through Thursday, (10) hours per day. All work over ten (10) hours in a day or forty (40) hours in a week shall be at the overtime rate of one and one-half (1½) times the regular hourly rate. The regular workday shall be either eight (8) or ten (10) hours. If a job can't work forty (40) hours Monday through Friday because of inclement weather or other conditions beyond the control of the Employer, Friday or Saturday may be worked as a make-up day at straight time (if working 4-10's). Saturday may be worked as a make-up day at straight time (if working 5-8's). An Employer, who is working a four (4) ten (10) hour day work schedule may use Friday as a make-up day when a workday is lost due to a holiday. A workday is to begin at the option of the Employer but not later than 11:00 a.m. except when inclement weather, requirements of the owner or other conditions beyond the reasonable control of the Employer prevent work. Except as worked as a make-up day, time on Saturday shall be worked at one and one-half (1½) times the regular rate. Work performed on Sunday shall be paid at two (2) times the regular rate. Work performed on recognized holidays or days observed as such, shall also be paid at the double (2) time rate of pay. For all overtime hours worked during the week or on Saturday \$15.55 of the fringe benefits portion of the prevailing wage shall be paid at time and one-half (1½). For all overtime hours worked on Sundays or recognized holidays \$15.55 of the fringe benefits portion of the prevailing wage shall be paid double time. The remaining \$.55 of the fringe benefit portion of the prevailing wage shall be paid at straight time.

**ANNUAL WAGE ORDER NO. 23**

**REPLACEMENT PAGE  
JEFFERSON COUNTY  
OVERTIME SCHEDULE - HEAVY CONSTRUCTION**

**NO. 25:** Means a regular work week of forty (40) hours, starting on Monday and ending on Friday. The regular work day shall be either eight (8) or ten (10) hours. If a crew is prevented from working forty (40) hours Monday through Friday, or any part thereof by reason of inclement weather, Saturday or any part thereof maybe worked as a make-up day at the straight time rate. Employees who are part of a regular crew on a make-up day, notwithstanding the fact that they may not have been employed the entire week, shall work Saturday at the straight time rate. A work day is to begin between 6:00 a.m. and 9:00 a.m. However, the project starting time maybe advanced or delayed if mutually agreed to by the interest parties. All hours worked on recognized holidays, or days observed as such, double (2) time shall be paid.

**NO. 26:** Means a regular work week of forty (40) hours will start on Monday and end on Friday. The regular work day shall be either eight (8) or ten (10) hours. If a crew is prevented from working forty (40) hours Monday through Friday, or any part thereof by reason of inclement weather, Saturday or any part thereof may be worked as a make-up day at the straight time rate. Employees who are part of a regular crew on a make-up day, notwithstanding the fact that they may not have been employed the entire week, shall work Saturday at the straight time rate. A workday is to begin between 6:00 a.m. and 9:00 a.m. However, the project starting time may be advanced or delayed if mutually agreed to by the interest parties. For all time worked on recognized holidays, or days observed as such, double (2) time shall be paid.

**NO. 32:** Means the overtime rate shall be time and one-half the regular rate for work over forty (40) hours per week. Sundays and Holidays shall be paid at double the straight time rate.

ANNUAL WAGE ORDER NO. 23

**JEFFERSON COUNTY  
HOLIDAY SCHEDULE – HEAVY CONSTRUCTION**

**NO. 4:** All work performed on New Year's Day, Memorial Day, Independence Day, Labor Day, Thanksgiving Day, Christmas Day, or observed as such, shall be paid at the double time rate of pay. When a Holiday falls on a Sunday, Monday shall be observed. No work shall be performed on Labor Day, except in case of jeopardy to life or property. This is applied to protect Labor Day.

**NO. 9:** All work performed on Sundays and the following recognized holidays, or the days observed as such, of New Year's Day, Decoration Day, Fourth of July, Labor Day, Veteran's Day, Thanksgiving Day and Christmas Day, shall be paid at double (2) the hourly rate plus an amount equal to the hourly Total Indicated Fringe Benefits. Whenever any such holidays fall on a Sunday, the following Monday shall be observed as a holiday.

**NO. 11:** Means all work performed on New Year's Day, Memorial Day, Fourth of July, Labor Day, Veteran's Day, Thanksgiving Day, Christmas Day, and any additional holidays which may be mutually agreed upon shall be paid at the double (2) time rate of pay. Whenever any such holiday falls on a Sunday, the following Monday shall be recognized and observed as the holiday. No work shall be performed on Labor Day.

**NO. 12:** All work performed on New Year's Day, Memorial Day, Fourth of July, Labor Day, Veteran's Day, Thanksgiving Day, Christmas Day, or days celebrated as such, shall be paid at the double time rate of pay. When one of the foregoing holidays falls on Sunday, it shall be celebrated on the following Monday. When one of the foregoing holidays falls on Saturday, it shall be celebrated on the Friday before the holiday.

**NO. 16:** The following days are recognized as holidays: New Year's Day, Memorial Day, Fourth of July, Labor Day, Thanksgiving Day and Christmas Day. If a holiday falls on Sunday, it shall be observed on the following Monday. If a holiday falls on Saturday, it shall be observed on the preceding Friday. No work shall be performed on Labor Day except in case of jeopardy to work under construction. This rule is applied to protect Labor Day. When a holiday falls during the normal work week, Monday through Friday, it shall be counted as eight (8) hours toward the forty (40) hour week; however, no reimbursement for this eight (8) hours is to be paid to the worker unless worked. If workers are required to work the above recognized holidays or days observed as such, they shall receive double (2) the regular rate of pay for such work.

**NO. 21:** The following days are recognized as holidays: New Year's Day, Memorial Day, Independence Day, Labor Day, Thanksgiving Day and Christmas Day. If a holiday falls on a Sunday, it shall be observed on the following Monday. No work shall be performed on Labor Day except in case of jeopardy to work under construction. This rule is applied to protect Labor Day. When a holiday falls during the normal work week, Monday through Friday, it shall be counted as eight (8) hours toward the forty (40) hour week; however, no reimbursement for this eight (8) hours is to be paid the workman unless worked. An Employer working a four (4) day, ten (10) hour schedule may use Friday as a make-up day when an observed holiday occurs during the work week. Employees have the option to work that make-up day. If workmen are required to work the above enumerated holidays, or days observed as such, they shall receive double (2) the regular rate of pay for such work.

**NO. 25:** The following days are recognized as holidays: New Year's Day, Memorial Day, Independence Day, Labor Day, Thanksgiving Day and Christmas Day. If a holiday falls on a Sunday, it shall be observed on the following Monday. No work shall be performed on Labor Day except in case of jeopardy to work under construction. This rule is applied to protect Labor Day. When a holiday falls during the normal work week, Monday through Friday, it shall be counted as eight (8) hours toward the forty (40) hour week; however, no reimbursement for this eight (8) hours is to be paid the workmen unless worked. An Employer working a four (4) day, ten (10) hour schedule may use Friday as a make up day when an observed holiday occurs during the work week. Employees have the option to work that make up day. If workmen are required to work the above enumerated holidays, or days observed as such, they shall receive double (2) the regular rate of pay for such work.

**NO. 31:** All work performed on New Year's Day, Presidents' Day, Veterans' Day, Good Friday, Decoration Day, Fourth of July, Labor Day, Christmas Eve Day, Christmas Day, Thanksgiving Day and Day after Thanksgiving or days celebrated for the same.

In Witness thereof, the parties hereto have executed this Agreement, in triplicate, as of this 24 day of January 2017 2016:

EA Boyer Bldg & Design, Inc  
Company Name

County of Jefferson, State of Missouri

Edward Boyer  
Signature

Kenneth Waller  
Kenneth B. Waller County Executive

Edward Boyer  
Print

Company Address: \_\_\_\_\_

1701 Towne View Dr

DeSoto, MO 63020

Phone: 636-337-9119

I hereby certify under section 50.660 RSMo there is either: (1) a balance of funds, otherwise unencumbered, to the credit of the appropriation to which the obligation contained herein is chargeable; and a cash balance otherwise unencumbered, in the treasury, to the credit of the funds from which payment is to be made, each sufficient to meet the obligation contained herein; or (2) bonds or taxes have been authorized by vote of the people and there is a sufficient unencumbered amount of the bonds yet to be sold or of the taxes levied and yet to be collected to meet the obligation in case there is not a sufficient unencumbered cash balance in the treasury.

[Signature]  
County Auditor

APPROVED AS TO FORM

[Signature]  
County Counselor

## COOPERATIVE BID FORM

Bid Name: Recorder's Office Remodel

**INSTRUCTIONS:** Bidders **MUST** fill out this form as part of the bidding process and attach to your bid response to Jefferson County, Missouri.

### COOPERATIVE PROCUREMENT CONTRACT

This is a cooperating supply contract in accordance with Chapter 130, Section 130.020. K.3., of the Procurement Policy and Procedures, Jefferson County Code of Ordinances.

**Will you extend bid prices, cash terms, and all other terms and conditions of any contract resulting from this bid with Jefferson County, Missouri, to any Jefferson County, Missouri, Municipality, government agency, district, sub-district or other tax-supported entity?**

Yes \_\_\_\_\_ No x

Although agreeing to the extension of the terms of this contract to municipalities or other tax-supported entities, *is not a prerequisite for award*, Jefferson County, Missouri, may take this factor into consideration if tie bids are received, in addition to the normal Terms and Conditions of the Invitation for Bid, enclosed herewith as a part of this bid.

**Bidders are encouraged to extend contract prices to  
Municipalities and any other tax-supported entities.**

If agreeable to the above, state the **minimum** dollar value *per order* you will require from a Municipality or any other tax-supported entity (this shall not apply to Jefferson County, Missouri Government, Departments or Divisions):

MINIMUM DOLLAR VALUE PER ORDER: \$ NA

BY: Edward Boyer

TITLE: President

COMPANY: EA Boyer Bldg & Design, Inc

#### CONTACT INFORMATION FOR COOPERATIVE AGREEMENT

Phone 636-337-9119 E-mail eaboyer9119@sbcglobal.net

**THIS FORM WILL BECOME PART OF THE BID DOCUMENT PACKAGE SUBMITTED TO  
JEFFERSON COUNTY, MISSOURI**